

DIRECT DRIVE SCREWDRIVERS

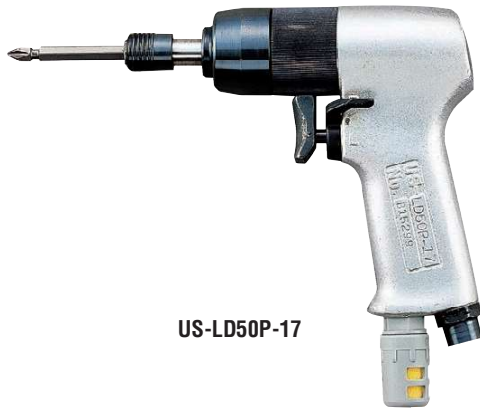

US-LD50P-17



US-LD40P-21

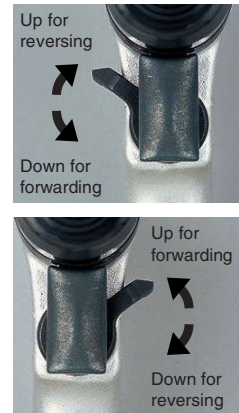

By replacing Reverse Lever, Operator can use either left or right hand.

SCREWDRIVERS

SPECIFICATIONS

Recommended Air Pressure : 0.5MPa (72psi)

Model	Capacity (Screw Size)		Torque Range				Free Speed (about)	Overall Length (about)		Weight Less Bit (about)		From Center to Outside (about)		Average Air Consumption		Code
			Soft Joint		Hard Joint											
	mm	in	Nm	ft-lbs	Nm	ft-lbs	min ⁻¹	mm	in	kg	lb	mm	in	m ³ /min	ft ³ /min	
US-LD40P-21	4	No.8	2.0	1.5	2.8	2.1	2500	130	5 1/14	0.7	1.54	17.0	43/64	0.40	14.0	42522
US-LD40P-15	4	No.8	3.0	2.2	3.2	2.4	1700	130	5 1/14	0.7	1.54	17.0	43/64	0.40	14.0	42532
US-LD40P-08	5	No.10	4.8	3.6	5.7	4.2	940	130	5 1/14	0.7	1.54	17.0	43/64	0.40	14.0	42542
US-LD50P-17	4	No.8	3.5	2.6	5.9	4.4	1900	150	5 29/32	0.9	2.01	20.0	49/64	0.50	17.5	42622
US-LD50P-08	5	No.10	6.5	4.8	7.8	5.8	900	153	6 1/32	0.9	2.01	20.0	49/64	0.50	17.5	42632
US-LD50P-05	5	No.10	10.0	7.4	11.2	8.3	500	153	6 1/32	0.9	2.01	20.0	49/64	0.50	17.5	42642

Air Inlet Size : NPT1/4" Air Hose Size : 6.35mm (1/4") Hex.Size of Bit : 6.35mm (1/4")