

Dimensions

Model	Material	Type	Cross-Sectional Dimensions top width (mm)×thickness (mm)×angle (°)	Minimum Pulley Diameter(mm)	Highest Speed (m/sec)
SUPER TORQUE Timing Belt (Round tooth)	Rubber	S2M	Pitch (mm) 2.00	9	30 (40)
		S3M	3.00	13	30 (40)
		S5M	5.00	22	30 (40)
		S8M	8.00	56	30 (40)
		S14M	14.00	125	30 (40)
	Polyurethane	S2M	2.00	9	30 (40)
		S3M	3.00	13	30 (40)
MEGA TORQUE Timing Belt	Rubber	MTS5M	Pitch (mm) 5.00	22	30
		MTS8M	8.00	56	30
		MTS14M	14.00	125	30
	Polyurethane	MTS8M	Pitch (mm) 8.00	61	30
GIGA TORQUE Timing Belt	Rubber	G8M	Pitch (mm) 8.000	56	30
		G14M	Pitch (mm) 14.00	125	30
Timing Belt (Trapezoidal tooth)	Rubber	MXL	Pitch (mm) 2.032	7	30 (40)
		XL	5.08	16	30 (40)
		L	9.525	30	30 (40)
		H	12.700	57	30 (40)
		XH	22.225	127	30 (40)
		XXH	31.750	182	30 (40)
	Polyurethane	T80	Pitch (mm) 2.032	7	30 (40)
		T5•DT5	5.0	19	30 (40)
		T10•DT10	10.0	45	30 (40)
		XL	5.08	16	30 (40)
		L	9.525	30	30 (40)
Classical V-Belt	Rubber	A	12.5×9.0×40	95 (67)	30
		B	16.5×11.0×40	150 (118)	30
		C	22.0×14.0×40	224 (180)	30
		D	31.5×10.0×40	355 (300)	30
		E	38.0×25.5×40	560 (450)	30
MAXSTAR WEDGE V-Belt	Rubber	3V	9.5×8.0×40	67	40
		5V	15.9×13.5×40	180	40
		8V	25.4×22.0×40	315	40
Multi MAXSTAR WEDGE V-Belt (Joined V-Belt)	Rubber	3V	—	67	40
		5V	—	180	40
		8V	—	315	40
RIBSTAR Belt (V-Ribbed Belt)	Rubber	J	Pitch (mm) 2.34	31.5 (25)	40 (50)
		PK	3.56	56 (50)	40 (50)
		L	4.70	90 (80)	40 (50)
	Polyurethane	JT•JBT	Pitch (mm) 2.34	20	30 (35)
FLEXSTAR® Belt	Rubber	FL	Belt Thickness (mm) 1.5	16	40 (60)
		FM	2.5	40	40 (60)
		FH	3.5	80	40 (60)
POLYMAX Belt	Polyurethane	3M	3.0×2.0×60	17	40
		5M	5.0×3.0×60	26	40
		7M	7.0×5.0×60	42	40
		11M	11.0×7.0×60	67	40
MB Belt (Polyurethane V-Belt)	Polyurethane	MB	6.0×4.0×40	16	10
STARROPE® / SUPER STARROPE®	Polyurethane	2	Diameter φ mm 2	15/ 20 SUPER	10 and below
		3	3	20/ 30	10
		4	4	30/ 40	10
		5	5	40/ 50	10
		6	6	50/ 60	10
		7	7	60/ 70	10
		8	8	70/ 80	10
		9	9	85/ 90	10
		10	10	95/ 100	10
		12	12	120/ 120	10
		15	15	150/ 150	10
PRENE V-ROPE	Polyurethane	M	10.0×5.5×40	40	10 and below
		A	12.5×8.5×40	85	10
		B	16.5×10.5×40	100	10
PRENE HEXAGONAL-ROPE	Polyurethane	AA	12.5×10.0×40	100	10 and below
		BB	16.5×12.5×40	130	10

Note 1 Values in () are only used under limited conditions. Avoid these values as much as possible.

The conditions of use such as pulley diameter and speed affect belt durability.

(Use the above table as a reference when selecting belts)

Note 2 For V-Belt and MAXSTAR WEDGE V-Belt, values are nominal.

I Synchronous Power Transmission

Round Tooth Timing Belt

Belt Type, Dimensions & Product Code	P13
SUPER TORQUE Timing Belt G	P14~16
SUPER TORQUE Timing Pulley.....	P17
MEGA TORQUE Timing Belt G&U	P18,19
Mega Torque GII	P20
Mega Torque EX	P21
Giga Torque GX.....	P22
H Series	P23

Trapezoidal Tooth Timing Belt

Belt Type, Dimensions & Product Code	P24
green eco® Series	P25
Timing Belt G	P26~28
Timing Belt U	P29~31
LONG-SPAN Timing Belt	P32
Timing Pulley	P33, 34



Round Tooth Timing Belt

I Synchronous Power Transmission

Belt Type, Dimensions & Product Code

Belt Type	Standard Dimensions	Standard Width		Product Code	Minimum Pulley Size *1		Applications																																																										
		Code	Width		Pulley diameter (mm)	No. of teeth																																																											
S2M	<p>Pitch Line</p> <p>Belt Tooth Pitch 2mm</p>	40	4mm	B 40 S2M 160 GB · (U) Belt Belt Type GB Type (bare back) ----- ----- ----- Nominal Length (mm) Belt Width(mm)x10 U(polyurethane) Type	8.91	14	<ul style="list-style-type: none"> ● OA Equipment <ul style="list-style-type: none"> Copier Fascimille Printer Typewriter Wordprocessor Computer terminal Cash register X-Y plotter ● Automated Vending Machine <ul style="list-style-type: none"> Ticketing machine Ticket gate Bank teller Notes counter Money changing machine 																																																										
		60	6mm					100	10mm	S3M	<p>Pitch Line</p> <p>Belt Tooth Pitch 3mm</p>	60	6mm	B 100 (D)S3M 459 GB·(U) Belt Belt Type GB Type (bare back) ----- ----- ----- Nominal Length (mm) Belt Width(mm)x10 U(polyurethane) Type * In case of double timing belt, use DS3M	13.37	14	<ul style="list-style-type: none"> ● Electronic Applications <ul style="list-style-type: none"> Computer VTR Fish sonar finder Flaw-detecting machine Depth finder Robot ● Instrumentation <ul style="list-style-type: none"> Rotary machine Recorder Oscillograph Data processing system Various test machines 	100	10mm	150	15mm	S5M	<p>Pitch Line</p> <p>Belt Tooth Pitch 5mm</p>	100	10mm	B 250 (D)S5M 1125 GB Belt Belt Type GB Type (bare back) ----- ----- ----- Nominal Length (mm) Belt Width(mm)x10 * In case of double timing belt, use DS5M	22.28	14	<ul style="list-style-type: none"> ● Electrical Appliances <ul style="list-style-type: none"> Blender Mixer Sewing machine Vacuum cleaner Eletrical tools ● Others <ul style="list-style-type: none"> Toy Medical systems Health equipment 	150	15mm	250	25mm	S8M	<p>Pitch Line</p> <p>Belt Tooth Pitch 8mm</p>	150	15mm	250 (D)S8M 2000 G Belt Width (mm)x10 Nominal Length (mm) Belt Type ----- ----- ----- * In case of double timing belt, use DS8M G(rubber) Type	56.02	22	<ul style="list-style-type: none"> ● Woodworking machinery ● Textile machinery <ul style="list-style-type: none"> Textile spinning machine Yarn twisting machine ● Paper making machinery <ul style="list-style-type: none"> Mixer Dryer Calender ● Fan/ Blower ● Machine tools <ul style="list-style-type: none"> Drilling machine, lathe Screw cutting machine Boring machine Grinding machine Milling machine NC lathe ● Printer 	250	25mm	300	30mm	400	40mm	600	60mm	S14M	<p>Pitch Line</p> <p>Belt Tooth Pitch 14mm</p>	400	40mm	800 (D)S14M 3150 G Belt Width (mm)x10 Nominal Length (mm) Belt Type ----- ----- ----- * In case of double timing belt, use DS14M G(rubber) Type	124.78	28	<ul style="list-style-type: none"> ● Blower ● Screen ● Mill hammer <ul style="list-style-type: none"> Ball Rod Pebble ● Paper making machinery <ul style="list-style-type: none"> Mixer Dryer Calender 	600	60mm	800	80mm	1000	100mm	1200	120mm
S3M	<p>Pitch Line</p> <p>Belt Tooth Pitch 3mm</p>	60	6mm	B 100 (D)S3M 459 GB·(U) Belt Belt Type GB Type (bare back) ----- ----- ----- Nominal Length (mm) Belt Width(mm)x10 U(polyurethane) Type * In case of double timing belt, use DS3M	13.37	14	<ul style="list-style-type: none"> ● Electronic Applications <ul style="list-style-type: none"> Computer VTR Fish sonar finder Flaw-detecting machine Depth finder Robot ● Instrumentation <ul style="list-style-type: none"> Rotary machine Recorder Oscillograph Data processing system Various test machines 																																																										
		100	10mm					150	15mm			S5M	<p>Pitch Line</p> <p>Belt Tooth Pitch 5mm</p>					100	10mm	B 250 (D)S5M 1125 GB Belt Belt Type GB Type (bare back) ----- ----- ----- Nominal Length (mm) Belt Width(mm)x10 * In case of double timing belt, use DS5M	22.28			14	<ul style="list-style-type: none"> ● Electrical Appliances <ul style="list-style-type: none"> Blender Mixer Sewing machine Vacuum cleaner Eletrical tools ● Others <ul style="list-style-type: none"> Toy Medical systems Health equipment 					150	15mm	250	25mm			S8M	<p>Pitch Line</p> <p>Belt Tooth Pitch 8mm</p>					150	15mm	250 (D)S8M 2000 G Belt Width (mm)x10 Nominal Length (mm) Belt Type ----- ----- ----- * In case of double timing belt, use DS8M G(rubber) Type	56.02	22	<ul style="list-style-type: none"> ● Woodworking machinery ● Textile machinery <ul style="list-style-type: none"> Textile spinning machine Yarn twisting machine ● Paper making machinery <ul style="list-style-type: none"> Mixer Dryer Calender ● Fan/ Blower ● Machine tools <ul style="list-style-type: none"> Drilling machine, lathe Screw cutting machine Boring machine Grinding machine Milling machine NC lathe ● Printer 	250	25mm			300	30mm					400	40mm	600	60mm	S14M	<p>Pitch Line</p> <p>Belt Tooth Pitch 14mm</p>	400	40mm
		S5M	<p>Pitch Line</p> <p>Belt Tooth Pitch 5mm</p>					100	10mm	B 250 (D)S5M 1125 GB Belt Belt Type GB Type (bare back) ----- ----- ----- Nominal Length (mm) Belt Width(mm)x10 * In case of double timing belt, use DS5M	22.28			14	<ul style="list-style-type: none"> ● Electrical Appliances <ul style="list-style-type: none"> Blender Mixer Sewing machine Vacuum cleaner Eletrical tools ● Others <ul style="list-style-type: none"> Toy Medical systems Health equipment 																																																		
150	15mm			250	25mm	S8M	<p>Pitch Line</p> <p>Belt Tooth Pitch 8mm</p>	150	15mm							250 (D)S8M 2000 G Belt Width (mm)x10 Nominal Length (mm) Belt Type ----- ----- ----- * In case of double timing belt, use DS8M G(rubber) Type	56.02	22	<ul style="list-style-type: none"> ● Woodworking machinery ● Textile machinery <ul style="list-style-type: none"> Textile spinning machine Yarn twisting machine ● Paper making machinery <ul style="list-style-type: none"> Mixer Dryer Calender ● Fan/ Blower ● Machine tools <ul style="list-style-type: none"> Drilling machine, lathe Screw cutting machine Boring machine Grinding machine Milling machine NC lathe ● Printer 			250	25mm			300	30mm	400	40mm	600	60mm	S14M	<p>Pitch Line</p> <p>Belt Tooth Pitch 14mm</p>									400	40mm					800 (D)S14M 3150 G Belt Width (mm)x10 Nominal Length (mm) Belt Type ----- ----- ----- * In case of double timing belt, use DS14M G(rubber) Type	124.78	28	<ul style="list-style-type: none"> ● Blower ● Screen ● Mill hammer <ul style="list-style-type: none"> Ball Rod Pebble ● Paper making machinery <ul style="list-style-type: none"> Mixer Dryer Calender 	600	60mm	800	80mm	1000	100mm	1200	120mm						
S8M	<p>Pitch Line</p> <p>Belt Tooth Pitch 8mm</p>			150	15mm			250 (D)S8M 2000 G Belt Width (mm)x10 Nominal Length (mm) Belt Type ----- ----- ----- * In case of double timing belt, use DS8M G(rubber) Type	56.02			22	<ul style="list-style-type: none"> ● Woodworking machinery ● Textile machinery <ul style="list-style-type: none"> Textile spinning machine Yarn twisting machine ● Paper making machinery <ul style="list-style-type: none"> Mixer Dryer Calender ● Fan/ Blower ● Machine tools <ul style="list-style-type: none"> Drilling machine, lathe Screw cutting machine Boring machine Grinding machine Milling machine NC lathe ● Printer 																																																				
		250	25mm	300	30mm					400	40mm			600	60mm					S14M	<p>Pitch Line</p> <p>Belt Tooth Pitch 14mm</p>	400	40mm	800 (D)S14M 3150 G Belt Width (mm)x10 Nominal Length (mm) Belt Type ----- ----- ----- * In case of double timing belt, use DS14M G(rubber) Type	124.78	28	<ul style="list-style-type: none"> ● Blower ● Screen ● Mill hammer <ul style="list-style-type: none"> Ball Rod Pebble ● Paper making machinery <ul style="list-style-type: none"> Mixer Dryer Calender 	600	60mm	800	80mm			1000	100mm			1200	120mm																										
		S14M	<p>Pitch Line</p> <p>Belt Tooth Pitch 14mm</p>	400	40mm					800 (D)S14M 3150 G Belt Width (mm)x10 Nominal Length (mm) Belt Type ----- ----- ----- * In case of double timing belt, use DS14M G(rubber) Type	124.78			28	<ul style="list-style-type: none"> ● Blower ● Screen ● Mill hammer <ul style="list-style-type: none"> Ball Rod Pebble ● Paper making machinery <ul style="list-style-type: none"> Mixer Dryer Calender 																																																		
				600	60mm																	800	80mm					1000	100mm	1200	120mm																																		

*1 Minimum pulley diameter / number of teeth depend on revolution.
Use Timing belt catalogue for design.

SUPER TORQUE Timing Belt G

Since the round tooth shape allows smooth meshing with pulleys, this belt is the most suitable for applications which require high-accuracy and smooth revolution such as computers and office appliances.

- Improved flexibility of this belt enables use of smaller diameter pulleys
- Smooth meshing allows noiseless operation
- Usable with low shaft load
- Possible to transmit high torque with a small belt.

Standard Belt Sizes

Belt Type	S2M									
	Tooth Pitch 2.0(mm)									
	Code(width) 40(4mm) 60(6mm) 100(10mm)									
Product Code	No. of Teeth	Belt Pitch Length (mm)	Manufacturable Size		Product Code	No. of Teeth	Belt Pitch Length (mm)	Manufacturable Size		
			GB	U				GB	U	
S2M 66	33	66	○	—	S2M 320	160	320	○	○	
S2M 72	36	72	○	—	S2M 322	161	322	○	—	
S2M 74	37	74	○	—	S2M 324	162	324	○	—	
S2M 76	38	76	○	—	S2M 326	163	326	○	—	
S2M 78	39	78	○	—	S2M 328	164	328	○	—	
S2M 80	40	80	○	○	S2M 330	165	330	○	○	
S2M 84	42	84	○	○	S2M 334	167	334	○	○	
S2M 86	43	86	○	○	S2M 338	169	338	○	○	
S2M 88	44	88	○	○	S2M 340	170	340	○	○	
S2M 90	45	90	○	○	S2M 342	171	342	○	○	
S2M 98	49	98	○	○	S2M 344	172	344	○	○	
S2M 100	50	100	○	○	S2M 350	175	350	○	○	
S2M 102	51	102	○	○	S2M 354	177	354	○	○	
S2M 104	52	104	○	○	S2M 360	180	360	○	○	
S2M 106	53	106	○	○	S2M 364	182	364	○	○	
S2M 108	54	108	○	○	S2M 370	185	370	○	○	
S2M 110	55	110	○	○	S2M 372	186	372	○	○	
S2M 112	56	112	○	○	S2M 374	187	374	○	○	
S2M 114	57	114	○	○	S2M 376	188	376	○	○	
S2M 116	58	116	○	○	S2M 380	190	380	○	○	
S2M 118	59	118	○	○	S2M 386	193	386	○	○	
S2M 120	60	120	○	○	S2M 390	195	390	○	○	
S2M 122	61	122	○	○	S2M 396	198	396	○	○	
S2M 124	62	124	○	○	S2M 400	200	400	○	○	
S2M 126	63	126	○	○	S2M 402	201	402	○	○	
S2M 128	64	128	○	○	S2M 408	204	408	○	○	
S2M 130	65	130	○	○	S2M 410	205	410	○	○	
S2M 132	66	132	○	○	S2M 420	210	420	○	○	
S2M 134	67	134	○	○	S2M 426	213	426	○	○	
S2M 136	68	136	○	○	S2M 430	215	430	○	○	
S2M 138	69	138	○	○	S2M 434	217	434	○	○	
S2M 140	70	140	○	○	S2M 436	218	436	○	○	
S2M 142	71	142	○	○	S2M 438	219	438	○	○	
S2M 144	72	144	○	○	S2M 440	220	440	○	○	
S2M 146	73	146	○	○	S2M 442	221	442	○	○	
S2M 148	74	148	○	○	S2M 444	222	444	○	○	
S2M 150	75	150	○	○	S2M 448	224	448	○	○	
S2M 152	76	152	○	○	S2M 452	226	452	○	○	
S2M 156	78	156	○	○	S2M 456	228	456	○	○	
S2M 158	79	158	○	○	S2M 460	230	460	○	○	
S2M 160	80	160	○	○	S2M 464	232	464	○	○	
S2M 164	82	164	○	○	S2M 468	234	468	○	○	
S2M 168	83	168	○	○	S2M 474	237	474	○	○	
S2M 168	84	168	○	○	S2M 476	238	476	○	○	
S2M 170	85	170	○	○	S2M 480	240	480	○	○	
S2M 172	86	172	○	○	S2M 486	243	486	○	○	
S2M 174	87	174	○	○	S2M 488	244	488	○	○	
S2M 176	88	176	○	○	S2M 494	247	494	○	○	
S2M 178	89	178	○	○	S2M 500	250	500	○	○	
S2M 180	90	180	○	○	S2M 520	260	520	○	○	
S2M 182	91	182	○	○	S2M 524	262	524	○	○	
S2M 184	92	184	○	○	S2M 530	265	530	○	○	
S2M 186	93	186	○	○	S2M 550	275	550	○	○	
S2M 188	94	188	○	○	S2M 560	280	560	○	○	
S2M 190	95	190	○	○	S2M 572	286	572	○	○	
S2M 192	96	192	○	○	S2M 580	290	580	○	○	
S2M 194	97	194	○	○	S2M 586	293	586	○	○	
S2M 196	98	196	○	○	S2M 594	297	594	○	○	
S2M 198	99	198	○	○	S2M 600	300	600	○	○	
S2M 200	100	200	○	○	S2M 630	315	630	○	○	
S2M 202	101	202	○	○	S2M 638	319	638	○	○	
S2M 204	102	204	○	○	S2M 648	324	648	○	○	
S2M 206	103	206	○	○	S2M 656	328	656	○	○	
S2M 208	104	208	○	○	S2M 660	330	660	○	○	
S2M 210	105	210	○	○	S2M 672	336	672	○	○	
S2M 212	106	212	○	○	S2M 676	338	676	○	○	
S2M 214	107	214	○	○	S2M 694	347	694	○	○	
S2M 216	108	216	○	○	S2M 710	355	710	○	○	
S2M 218	109	218	○	○	S2M 726	363	726	○	○	
S2M 220	110	220	○	○	S2M 740	370	740	○	○	
S2M 224	112	224	○	○	S2M 752	376	752	○	○	
S2M 226	113	226	○	○	S2M 772	386	772	○	○	
S2M 230	115	230	○	○	S2M 778	389	778	○	○	
S2M 232	116	232	○	○	S2M 796	396	796	○	○	
S2M 234	117	234	○	○	S2M 800	400	800	○	○	
S2M 236	118	236	○	○	S2M 810	405	810	○	○	
S2M 238	119	238	○	○	S2M 822	411	822	○	○	
S2M 240	120	240	○	○	S2M 826	413	826	○	○	
S2M 242	121	242	○	○	S2M 828	414	828	○	○	
S2M 244	122	244	○	○	S2M 848	424	848	○	○	
S2M 246	123	246	○	○	S2M 856	428	856	○	○	
S2M 248	124	248	○	○	S2M 862	431	862	○	○	
S2M 250	125	250	○	○	S2M 866	433	866	○	○	
S2M 252	126	252	○	○	S2M 880	440	880	○	○	
S2M 254	127	254	○	○	S2M 882	441	882	○	○	
S2M 256	128	256	○	○	S2M 898	449	898	○	○	
S2M 258	129	258	○	○	S2M 900	450	900	○	○	
S2M 260	130	260	○	○	S2M 910	455	910	○	○	
S2M 262	131	262	○	○	S2M 930	465	930	○	○	
S2M 264	132	264	○	○	S2M 944	472	944	○	○	
S2M 266	133	266	○	○	S2M 950	475	950	○	○	
S2M 268	134	268	○	○	S2M 976	488	976	○	○	
S2M 270	135	270	○	○	S2M 984	492	984	○	○	
S2M 272	136	272	○	○	S2M 1015	508	1,015	○	○	
S2M 276	138	276	○	○	S2M 1032	516	1,032	○	○	
S2M 278	139	278	○	○	S2M 1062	531	1,062	○	○	
S2M 280	140	280	○	○	S2M 1064	532	1,064	○	○	
S2M 284	142	284	○	○	S2M 1066	533	1,066	○	○	
S2M 286	143	286	○	○	S2M 1100	550	1,100	○	○	
S2M 288	144	288	○	○	S2M 1136	568	1,136	○	○	
S2M 290	145	290	○	○	S2M 1140	570	1,140	○	○	
S2M 292	146	292	○	○	S2M 1196	598	1,196	○	○	
S2M 296	148	296	○	○	S2M 1224	612	1,224	○	○	
S2M 300	150	300	○	○	S2M 1250	625	1,250	○	○	
S2M 302	151	302	○	○	S2M 1274	637	1,274	○	○	
S2M 304	152	304	○	○	S2M 1290	645	1,290	○	○	
S2M 306	153	306	○	○	S2M 1330	665	1,330	○	○	
S2M 308	154	308	○	○	S2M 1420	710	1,420	○	○	
S2M 310	155	310	○	○	S2M 1516	758	1,516	○	○	
S2M 312	156	312	○	○	S2M 1524	762	1,524	○	○	
S2M 316	158	316	○	○	S2M 1878	939	1,878	○	○	
S2M 318	159	318	○	○	S2M 2130	1,065	2,130	○	○	

- For S2M and S3M, polyurethane (U) and rubber (GB) models are available. Choose the appropriate material for your application.
- (D) signifies the standard size of double timing belt GB (rubber) type.
- Sizes not indicated above are also available under limited conditions.

SUPER TORQUE Timing Belt G

Since this round tooth belt has a high power transmission property, it expands existing applications of timing belts significantly.

Also, it can be used as an alternative for chains and gears.

- It can be used in wide applications since it has a higher power transmission.
- Longer operating life
- Quiet operation
- Cost-Efficient

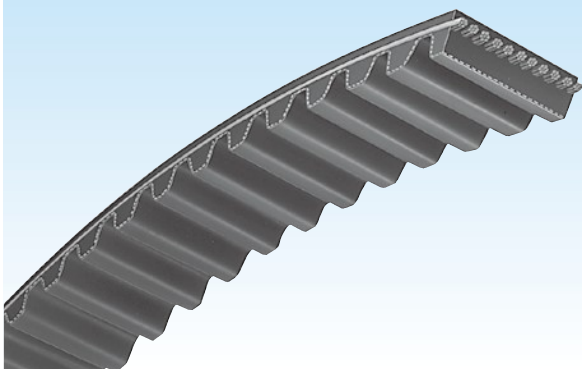

Standard Belt Sizes

Belt Type	S8M			S14M		
	8.0(mm)			14.0(mm)		
Tooth Pitch	8.0(mm)			14.0(mm)		
Code(width)	150(15mm)	250(25mm)	300(30mm) 400(40mm) 600(60mm)	400(40mm) 600(60mm) 800(80mm) 1000(100mm) 1200(120mm)		
	Product Code	No. of Teeth	Pitch Length (mm)	Product Code	No. of Teeth	Pitch Length (mm)
Size	S8M 376	47	376	S14M 1008	72	1,008
	S8M 400	50	400	S14M 1120	80	1,120
	S8M 408	51	408	S14M 1190	85	1,190
	S8M 440	55	440	S14M 1246	89	1,246
	S8M 480	60	480	S14M 1288	92	1,288
	S8M 496	62	496	(D) S14M 1400	100	1,400
	S8M 512	64	512	(D) S14M 1470	105	1,470
	S8M 520	65	520	(D) S14M 1540	110	1,540
	S8M 560	70	560	(D) S14M 1610	115	1,610
	(D) S8M 584	73	584	(D) S14M 1652	118	1,652
	(D) S8M 600	75	600			
	(D) S8M 632	79	632	(D) S14M 1708	122	1,708
	(D) S8M 640	80	640	(D) S14M 1736	124	1,736
	(D) S8M 656	82	656	(D) S14M 1750	125	1,750
	(D) S8M 680	85	680	(D) S14M 1778	127	1,778
	(D) S8M 712	89	712	(D) S14M 1806	129	1,806
	(D) S8M 720	90	720	(D) S14M 1890	135	1,890
	(D) S8M 760	95	760	(D) S14M 1932	138	1,932
	(D) S8M 800	100	800	(D) S14M 1960	140	1,960
	(D) S8M 824	103	824	(D) S14M 2002	143	2,002
	(D) S8M 840	105	840	(D) S14M 2100	150	2,100
	(D) S8M 848	106	848			
	(D) S8M 856	107	856	(D) S14M 2198	157	2,198
	(D) S8M 880	110	880	(D) S14M 2240	160	2,240
	(D) S8M 896	112	896	(D) S14M 2310	165	2,310
	(D) S8M 912	114	912	(D) S14M 2380	170	2,380
	(D) S8M 920	115	920	(D) S14M 2450	175	2,450
	(D) S8M 928	116	928	(D) S14M 2506	179	2,506
	(D) S8M 944	118	944	(D) S14M 2590	185	2,590
	(D) S8M 952	119	952	(D) S14M 2660	190	2,660
	(D) S8M 960	120	960	(D) S14M 2800	200	2,800
	(D) S8M 976	122	976	(D) S14M 3150	225	3,150
	(D) S8M 984	123	984			
	(D) S8M 1000	125	1,000	(D) S14M 3360	240	3,360
	(D) S8M 1024	128	1,024	(D) S14M 3500	250	3,500
	(D) S8M 1040	130	1,040	(D) S14M 3556	254	3,556
	(D) S8M 1056	132	1,056	(D) S14M 3850	275	3,850
	(D) S8M 1080	135	1,080	(D) S14M 4004	286	4,004
	(D) S8M 1120	140	1,120	(D) S14M 4508	322	4,508
	(D) S8M 1128	141	1,128	(D) S14M 5012	358	5,012
	(D) S8M 1136	142	1,136			
	(D) S8M 1152	144	1,152			
	(D) S8M 1160	145	1,160			
	(D) S8M 1184	148	1,184			
	(D) S8M 1200	150	1,200			
	(D) S8M 1216	152	1,216			
	(D) S8M 1224	153	1,224			
	(D) S8M 1248	156	1,248			
	(D) S8M 1256	157	1,256			
	(D) S8M 1280	160	1,280			
	(D) S8M 1296	162	1,296			
	(D) S8M 1304	163	1,304			
	(D) S8M 1312	164	1,312			
	(D) S8M 1320	165	1,320			
	(D) S8M 1352	169	1,352			
	(D) S8M 1360	170	1,360			
	(D) S8M 1384	173	1,384			
	(D) S8M 1400	175	1,400			
	(D) S8M 1424	178	1,424			
	(D) S8M 1440	180	1,440			
	(D) S8M 1480	185	1,480			
	(D) S8M 1488	186	1,488			
	(D) S8M 1520	190	1,520			
	(D) S8M 1552	194	1,552			
	(D) S8M 1600	200	1,600			
	(D) S8M 1640	205	1,640			
	(D) S8M 1648	206	1,648			
	(D) S8M 1680	210	1,680			
	(D) S8M 1696	212	1,696			
	(D) S8M 1728	216	1,728			
	(D) S8M 1760	220	1,760			
	(D) S8M 1776	222	1,776			
	(D) S8M 1792	224	1,792			
	(D) S8M 1800	225	1,800			
	(D) S8M 1816	227	1,816			
	(D) S8M 1832	229	1,832			
	(D) S8M 1880	235	1,880			
	(D) S8M 1912	230	1,912			
	(D) S8M 1960	245	1,960			
	(D) S8M 2000	250	2,000			
	(D) S8M 2040	255	2,040			
	(D) S8M 2048	256	2,048			
	(D) S8M 2064	258	2,064			
	(D) S8M 2104	263	2,104			
	(D) S8M 2120	260	2,120			
	(D) S8M 2160	270	2,160			
	(D) S8M 2240	280	2,240			
	(D) S8M 2272	284	2,272			
	(D) S8M 2304	288	2,304			
	(D) S8M 2376	297	2,376			
	(D) S8M 2400	300	2,400			
	(D) S8M 2496	312	2,496			
	(D) S8M 2600	325	2,600			
	(D) S8M 2800	350	2,800			
	(D) S8M 2920	365	2,920			
	(D) S8M 2944	368	2,944			
	(D) S8M 3048	381	3,048			
	(D) S8M 3200	400	3,200			
	(D) S8M 3248	406	3,248			
	(D) S8M 3272	409	3,272			
(D) S8M 3440	430	3,440				
(D) S8M 3680	460	3,680				
(D) S8M 3720	465	3,720				
(D) S8M 3904	488	3,904				
(D) S8M 3928	491	3,928				
(D) S8M 4400	550	4,400				

- Keep in mind that not all the sizes in above chart are in-stock items.
- (D) signifies the standard size of double timing belt G (rubber) type.

SUPER TORQUE Timing Pulley



Timing belt power transmission system works the best when belt and pulley smoothly mesh with each other. Our SUPER TORQUE Timing Pulley is made with specially formed tooth shape and fine finishing.

Pulley Product Code

Example:

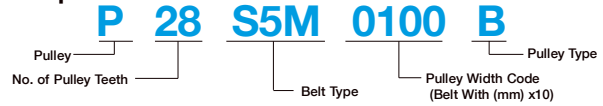

SUPER TORQUE Standard Pulley Types and Sizes

☆ We add aluminum as a standard pulley for S3M and S5M

Belt Type	S2M				S3M			S5M		
	No. of Teeth	Product Code	PD	OD	Product Code	PD	OD	Product Code	PD	OD
Size	14	P 14S2M	8.91	8.40	P 14S3M	13.37	12.61	P 14S5M	22.28	21.32
	15	P 15S2M	9.55	9.04	P 15S3M	14.32	13.56	P 15S5M	23.87	22.91
	16	P 16S2M	10.19	9.68	P 16S3M	15.28	14.52	P 16S5M	25.46	24.50
	18	P 18S2M	11.46	10.95	P 18S3M	17.19	16.43	P 18S5M	28.65	27.69
	20	P 20S2M	12.73	12.22	P 20S3M	19.10	18.34	P 20S5M	31.83	30.87
	22	P 22S2M	14.01	13.50	P 22S3M	21.01	20.25	P 22S5M	35.01	34.05
	24	P 24S2M	15.28	14.77	P 24S3M	22.92	22.16	P 24S5M	38.20	37.24
	25	P 25S2M	15.92	15.41	P 25S3M	23.87	23.11	P 25S5M	39.79	38.83
	26	P 26S2M	16.55	16.04	P 26S3M	24.83	24.07	P 26S5M	41.38	40.42
	28	P 28S2M	17.83	17.32	P 28S3M	26.74	25.98	P 28S5M	44.56	43.60
	30	P 30S2M	19.10	18.59	P 30S3M	28.65	27.89	P 30S5M	47.75	46.79
	32	P 32S2M	20.37	19.86	P 32S3M	30.56	29.80	P 32S5M	50.93	49.97
	36	P 36S2M	22.92	22.41	P 36S3M	34.38	33.62	P 36S5M	57.30	56.34
	40	P 40S2M	25.46	24.96	P 40S3M	38.20	37.44	P 40S5M	63.66	62.70
	44	P 44S2M	28.01	27.50	P 44S3M	42.02	41.25	P 44S5M	70.03	69.07
	48	P 48S2M	30.56	30.05	P 48S3M	45.84	45.07	P 48S5M	76.39	75.43
	50	P 50S2M	31.83	31.32	P 50S3M	47.75	46.98	P 50S5M	79.58	78.62
	60	P 60S2M	38.20	37.69	P 60S3M	57.30	56.53	P 60S5M	95.49	94.53

Standard Sizes

Type	10mm	15mm	25mm	Rod Shape
S2M	—	—	—	○
S3M	A·B·C	A·B·C	—	○
S5M	A·B	A·B	A·B	○

Materials

Type	A·B	C	Rod Shape
S2M	—	—	Aluminum
S3M	Aluminum	Aluminum	Aluminum
S5M	Aluminum/Steel	—	Steel

Pulley Types

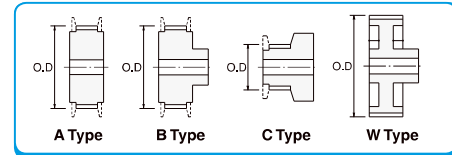

- Shape is a 100mm long round cylinder product.
- 22 teeth and below sizes of S3M are available only in rod shape and C type. Also, 24 teeth and above sizes are available only in A or B type.
- Only steel one is available for 25 mm width S5M type.
- Flange is not sold separately as a single item.

Belt Type	S8M						S14M						
	No. of Teeth	Product Code	PD	OD	A/B Type Standard Width	W Type Standard Width	No. of Teeth	Product Code	PD	OD	A Type Standard Width	B Type Standard Width	W Type Standard Width
Size	18	18S8M	45.84	44.46	15·25·30·40	—	28	P 28S14M	124.78	121.98	40·60·80	40·60	—
	19	19S8M	48.38	47.01		—	30	P 30S14M	133.69	130.90			—
	20	20S8M	50.93	49.56		—	32	P 32S14M	142.60	139.81			—
	21	21S8M	53.48	52.10		—	34	P 34S14M	151.52	148.72			—
	22	22S8M	56.02	54.65		—	36	P 36S14M	160.43	157.63			—
	24	24S8M	61.12	59.74		—	40	P 40S14M	178.25	175.46			—
	25	25S8M	63.66	62.29		—	42	P 42S14M	187.17	184.37			—
	26	26S8M	66.21	64.84		—	44	P 44S14M	196.08	193.28			—
	28	28S8M	71.30	69.93		—	48	P 48S14M	213.90	211.11			—
	30	30S8M	76.39	75.02		—	50	P 50S14M	222.82	220.02			—
	32	32S8M	81.49	80.12	15·25·30·40·60	—	56	P 56S14M	249.55	246.76	—	—	40·60
	34	34S8M	86.58	85.21		—	(60)	P 60S14M	267.38	264.59			
	36	36S8M	91.67	90.30		—	(64)	P 64S14M	285.21	282.41			
	38	38S8M	96.77	95.39		—	(72)	P 72S14M	320.86	318.06			
	40	40S8M	101.86	100.49		—	—	—	—	—			
	44	44S8M	112.05	110.67		—	—	—	—	—			
	48	48S8M	122.23	120.86		—	—	—	—	—			
	50	50S8M	127.32	125.95		—	—	—	—	—			
	60	60S8M	152.79	151.42		—	—	—	—	—			
	(72)	72S8M	183.35	181.97		—	15·25·40·60	—	—	—			
(84)	84S8M	213.90	212.53	—	—	—	—	—					
(96)	96S8M	244.46	243.09	—	25·40·60	—	—	—					
(120)	120S8M	305.58	304.21	—	—	—	—	—					

- No. of teeth in () is nonstocked item.
- Flange is not sold separately as a single item.
- A and B types are made from steel whereas W type is made from cast metal.

we revised the standard item lists in April, 2006.

MEGA TORQUE Timing Belt G&U

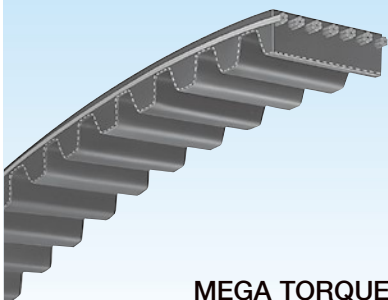

MEGA TORQUE Timing Belt G

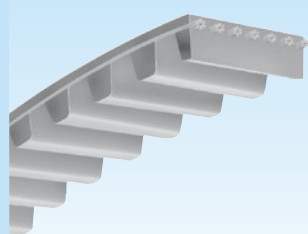

MEGA TORQUE Timing Belt U

Characteristics of low/high speed torque timing belt 'MEGA TORQUE' :

- Large transmission capacity is achievable, at about 2 times that of SUPER TORQUE G (Rubber) (variation subject to pulley diameter and revolution speed).
 - Compact design possible. Compared to SUPER TORQUE G (Rubber), width is approximately 40% smaller on average for the same pulley diameter.
 - Pulley of existing models can be used. SUPER TORQUE (S8M, S14M) pulleys can be used as per usual.
- * Please contact us regarding pulley for MTS5M.

MEGA TORQUE Timing Belt G

Dimensions

- Tooth Shape & Product Code -

MTS5M

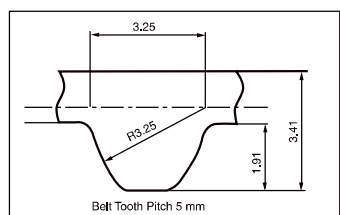

Standard Belt Width

Belt Width Code	Belt Width (mm)
100	10
150	15
250	25

2 5 0 | M T | S 5 M | 1 1 2 5 | G Rubber
 Belt Width (mm) x10 | MEGA TORQUE | Belt Type | Belt Length (mm)

MTS8M

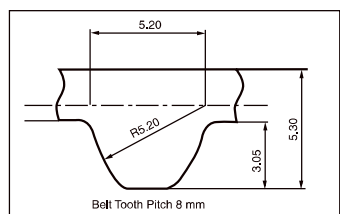

Standard Belt Width

Belt Width Code	Belt Width (mm)
150	15
250	25
300	30
400	40
600	60

2 5 0 | M T | S 8 M | 1 6 8 0 | G Rubber
 Belt Width (mm) x10 | MEGA TORQUE | Belt Type | Belt Length (mm)

MTS14M

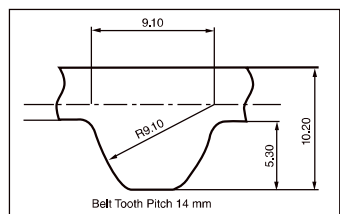

Standard Belt Width

Belt Width Code	Belt Width (mm)
400	40
600	60
800	80
1000	100
1200	120

6 0 0 | M T | S 1 4 M | 2 1 0 0 | G Rubber
 Belt Width (mm) x10 | MEGA TORQUE | Belt Type | Belt Length (mm)

Standard Belt Sizes

MTS5M(Pitch 5mm)			
Product Code	No. of Teeth	Product Code	No. of Teeth
MTS5M 225 G	45	MTS5M 830 G	166
MTS5M 255 G	51	MTS5M 845 G	169
MTS5M 260 G	52	MTS5M 850 G	170
MTS5M 295 G	59	MTS5M 870 G	174
MTS5M 300 G	60	MTS5M 890 G	178
MTS5M 305 G	61	MTS5M 900 G	180
MTS5M 320 G	64	MTS5M 930 G	186
MTS5M 325 G	65	MTS5M 950 G	190
MTS5M 340 G	68	MTS5M 965 G	193
MTS5M 350 G	70	MTS5M 975 G	195
MTS5M 370 G	74	MTS5M 980 G	196
MTS5M 375 G	75	MTS5M 1000 G	200
MTS5M 380 G	76	MTS5M 1025 G	205
MTS5M 390 G	78	MTS5M 1050 G	210
MTS5M 400 G	80	MTS5M 1055 G	211
MTS5M 410 G	82	MTS5M 1085 G	217
MTS5M 425 G	85	MTS5M 1090 G	218
MTS5M 435 G	87	MTS5M 1100 G	220
MTS5M 440 G	88	MTS5M 1105 G	221
MTS5M 450 G	90	MTS5M 1115 G	223
MTS5M 460 G	92	MTS5M 1120 G	224
MTS5M 470 G	94	MTS5M 1125 G	225
MTS5M 475 G	95	MTS5M 1135 G	227
MTS5M 490 G	98	MTS5M 1145 G	229
MTS5M 500 G	100	MTS5M 1160 G	232
MTS5M 520 G	104	MTS5M 1165 G	233
MTS5M 525 G	105	MTS5M 1195 G	239
MTS5M 530 G	106	MTS5M 1200 G	240
MTS5M 545 G	109	MTS5M 1225 G	245
MTS5M 550 G	110	MTS5M 1250 G	250
MTS5M 560 G	112	MTS5M 1270 G	254
MTS5M 575 G	115	MTS5M 1290 G	258
MTS5M 590 G	118	MTS5M 1295 G	259
MTS5M 595 G	119	MTS5M 1350 G	270
MTS5M 600 G	120	MTS5M 1420 G	284
MTS5M 615 G	123	MTS5M 1475 G	295
MTS5M 625 G	125	MTS5M 1500 G	300
MTS5M 640 G	128	MTS5M 1505 G	301
MTS5M 650 G	130	MTS5M 1530 G	306
MTS5M 665 G	133	MTS5M 1595 G	319
MTS5M 670 G	134	MTS5M 1605 G	321
MTS5M 675 G	135	MTS5M 1615 G	323
MTS5M 690 G	138	MTS5M 1680 G	336
MTS5M 695 G	139	MTS5M 1690 G	338
MTS5M 700 G	140	MTS5M 1715 G	343
MTS5M 710 G	142	MTS5M 1800 G	360
MTS5M 720 G	144	MTS5M 1945 G	389
MTS5M 725 G	145	MTS5M 2000 G	400
MTS5M 730 G	146	MTS5M 2145 G	429
MTS5M 740 G	148	MTS5M 2255 G	451
MTS5M 750 G	150	MTS5M 2480 G	496
MTS5M 765 G	153	MTS5M 2525 G	505
MTS5M 780 G	156	MTS5M 2980 G	596
MTS5M 800 G	160	MTS5M 3090 G	618
MTS5M 810 G	162		

MEGA TORQUE Timing Belt G&U

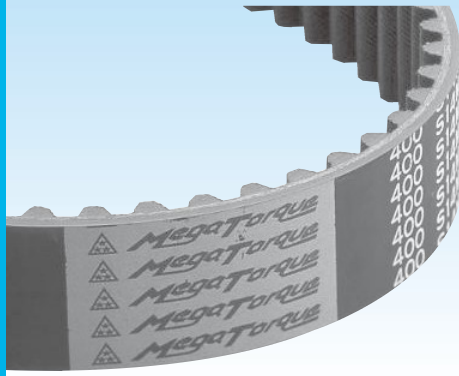

Standard Belt Sizes

MTS8M (Pitch 8 mm)				MTS14M (Pitch 14 mm)	
Product Code	No. of Teeth	Product Code	No. of Teeth	Product Code	No. of Teeth
MTS8M 528 G	66	MTS8M 1400 G	175	MTS14M 1008 G	72
MTS8M 560 G	70	MTS8M 1424 G	178	MTS14M 1120 G	80
MTS8M 584 G	73	MTS8M 1440 G	180	MTS14M 1190 G	85
MTS8M 600 G	75	MTS8M 1480 G	185	MTS14M 1246 G	89
MTS8M 632 G	79	MTS8M 1488 G	186	MTS14M 1288 G	92
MTS8M 640 G	80	MTS8M 1520 G	190	MTS14M 1400 G	100
MTS8M 656 G	82	MTS8M 1552 G	194	MTS14M 1470 G	105
MTS8M 712 G	89	MTS8M 1600 G	200	MTS14M 1540 G	110
MTS8M 720 G	90	MTS8M 1640 G	205	MTS14M 1610 G	115
MTS8M 760 G	95	MTS8M 1648 G	206	MTS14M 1652 G	118
MTS8M 800 G	100	MTS8M 1680 G	210	MTS14M 1708 G	122
MTS8M 824 G	103	MTS8M 1696 G	212	MTS14M 1736 G	124
MTS8M 840 G	105	MTS8M 1728 G	216	MTS14M 1750 G	125
MTS8M 848 G	106	MTS8M 1760 G	220	MTS14M 1778 G	127
MTS8M 856 G	107	MTS8M 1776 G	222	MTS14M 1806 G	129
MTS8M 880 G	110	MTS8M 1792 G	224	MTS14M 1890 G	135
MTS8M 896 G	112	MTS8M 1800 G	225	MTS14M 1932 G	138
MTS8M 912 G	114	MTS8M 1816 G	227	MTS14M 1960 G	140
MTS8M 920 G	115	MTS8M 1832 G	229	MTS14M 2002 G	143
MTS8M 928 G	116	MTS8M 1880 G	235	MTS14M 2100 G	150
MTS8M 944 G	118	MTS8M 1912 G	239	MTS14M 2198 G	157
MTS8M 952 G	119	MTS8M 1960 G	245	MTS14M 2240 G	160
MTS8M 960 G	120	MTS8M 2000 G	250	MTS14M 2310 G	165
MTS8M 976 G	122	MTS8M 2040 G	255	MTS14M 2380 G	170
MTS8M 984 G	123	MTS8M 2048 G	256	MTS14M 2450 G	175
MTS8M 1000 G	125	MTS8M 2064 G	258	MTS14M 2506 G	179
MTS8M 1024 G	128	MTS8M 2104 G	263	MTS14M 2590 G	185
MTS8M 1040 G	130	MTS8M 2120 G	265	MTS14M 2660 G	190
MTS8M 1056 G	132	MTS8M 2160 G	270	MTS14M 2800 G	200
MTS8M 1080 G	135	MTS8M 2240 G	280	MTS14M 3150 G	225
MTS8M 1120 G	140	MTS8M 2272 G	284	MTS14M 3360 G	240
MTS8M 1128 G	141	MTS8M 2304 G	288	MTS14M 3500 G	250
MTS8M 1136 G	142	MTS8M 2376 G	297	MTS14M 3556 G	254
MTS8M 1152 G	144	MTS8M 2400 G	300	MTS14M 3850 G	275
MTS8M 1160 G	145	MTS8M 2496 G	312	MTS14M 4004 G	286
MTS8M 1184 G	148	MTS8M 2600 G	325	MTS14M 4508 G	322
MTS8M 1200 G	150	MTS8M 2800 G	350	MTS14M 5012 G	358
MTS8M 1216 G	152	MTS8M 2920 G	365		
MTS8M 1224 G	153	MTS8M 2944 G	368		
MTS8M 1248 G	156	MTS8M 3048 G	381		
MTS8M 1256 G	157	MTS8M 3200 G	400		
MTS8M 1280 G	160	MTS8M 3248 G	406		
MTS8M 1296 G	162	MTS8M 3272 G	409		
MTS8M 1304 G	163	MTS8M 3440 G	430		
MTS8M 1312 G	164	MTS8M 3680 G	460		
MTS8M 1320 G	165	MTS8M 3720 G	465		
MTS8M 1352 G	169	MTS8M 3904 G	488		
MTS8M 1360 G	170	MTS8M 3928 G	491		
MTS8M 1384 G	173	MTS8M 4400 G	550		

MEGA TORQUE Timing Belt U

Dimensions

- Tooth Shape & Product Code -

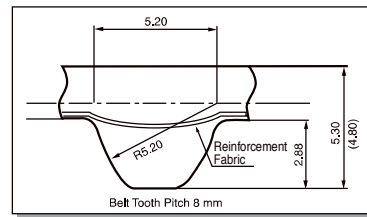

Standard Belt Width

Belt Width Code	Belt Width (mm)
150	15
250	25
400	40
600	60

2.50 | MT | S8M | 1000 | U
 Belt Width (mm) x10 | MEGA TORQUE | Belt Type | Belt Length (mm) | Polyurethane

Standard Belt Sizes

MTS8M (Pitch 8 mm)		
Product Code		No. of Teeth
MTS8M 560		70
MTS8M 600		75
MTS8M 640		80
MTS8M 680		85
MTS8M 720		90
MTS8M 760		95
* MTS8M 800		100
MTS8M 848		106
MTS8M 896		112
MTS8M 960		120
MTS8M 100		125
MTS8M 1056		132
MTS8M 112		140
MTS8M 1200		150
MTS8M 1280		160
* MTS8M 1328		166
MTS8M 1360		170
MTS8M 1440		180
MTS8M 15		190
MTS8M 1600		200
MTS8M 1696		212
* MTS8M 1792		224
* MTS8M 1888		236

● Total thickness of belt sizes with * mark is 4.8mm.

MEGATORQUE GII

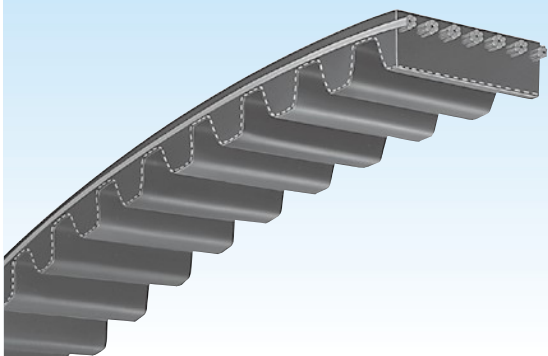

Characteristics and advantages of Extra High Torque Timing Belt

- Extra larger power transmission capacity
New material cord minimizes belt stretch and produces high power transmission capacity. Power transmission capacity is 1.5 times of MEGA TORQUE G.
- Long operation life
Introducing anti-abrasive low friction fabric brings high durability at higher torque. Belt life is 2 times longer than MEGA TORQUE G.
- Low noise
Running noise is reduced by 18% from regular timing belt when you use specially designed pulley and narrower width belt.
* Specially designed pulley is required.

● MTS8M

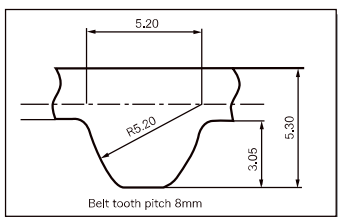

Standard Belt Width

Belt Width Code	Belt Width (mm)
150	15
250	25
300	30
400	40
600	60

250 **MT** **S8M** **1680** **G2**
 Belt Width (mm)x10 MEGA TORQUE Belt Type Belt Length (mm) G2 Specification

● MTS14M

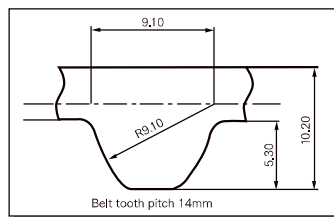

Standard Belt Width

Belt Width Code	Belt Width (mm)
400	40
600	60
800	80
1000	100
1200	120

600 **MT** **S14M** **2100** **G2**
 Belt Width (mm)x10 MEGA TORQUE Belt Type Belt Length (mm) G2 Specification

Standard Belt Sizes

MTS8M (Pitch 8 mm)

Product Code	No. of Teeth	Product Code	No. of Teeth	Product Code	No. of Teeth	Product Code	No. of Teeth
MTS8M 528 G2	66	MTS8M 1000 G2	125	MTS8M 1424 G2	178	MTS8M 2104 G2	263
MTS8M 560 G2	70	MTS8M 1024 G2	128	MTS8M 1440 G2	180	MTS8M 2120 G2	265
MTS8M 584 G2	73	MTS8M 1040 G2	130	MTS8M 1480 G2	185	MTS8M 2160 G2	270
MTS8M 600 G2	75	MTS8M 1056 G2	132	MTS8M 1488 G2	186	MTS8M 2240 G2	280
MTS8M 632 G2	79	MTS8M 1080 G2	135	MTS8M 1520 G2	190	MTS8M 2272 G2	284
MTS8M 640 G2	80	MTS8M 1120 G2	140	MTS8M 1552 G2	194	MTS8M 2304 G2	288
MTS8M 656 G2	82	MTS8M 1128 G2	141	MTS8M 1600 G2	200	MTS8M 2376 G2	297
MTS8M 712 G2	89	MTS8M 1136 G2	142	MTS8M 1640 G2	205	MTS8M 2400 G2	300
MTS8M 720 G2	90	MTS8M 1152 G2	144	MTS8M 1648 G2	206	MTS8M 2496 G2	312
MTS8M 760 G2	95	MTS8M 1160 G2	145	MTS8M 1680 G2	210	MTS8M 2600 G2	325
MTS8M 800 G2	100	MTS8M 1184 G2	148	MTS8M 1696 G2	212	MTS8M 2800 G2	350
MTS8M 824 G2	103	MTS8M 1200 G2	150	MTS8M 1728 G2	216	MTS8M 2920 G2	365
MTS8M 840 G2	105	MTS8M 1216 G2	152	MTS8M 1760 G2	220	MTS8M 2944 G2	368
MTS8M 848 G2	106	MTS8M 1224 G2	153	MTS8M 1776 G2	222	MTS8M 3048 G2	381
MTS8M 856 G2	107	MTS8M 1248 G2	156	MTS8M 1792 G2	224	MTS8M 3200 G2	400
MTS8M 880 G2	110	MTS8M 1256 G2	157	MTS8M 1800 G2	225	MTS8M 3248 G2	406
MTS8M 896 G2	112	MTS8M 1280 G2	160	MTS8M 1816 G2	227	MTS8M 3272 G2	409
MTS8M 912 G2	114	MTS8M 1296 G2	162	MTS8M 1832 G2	229	MTS8M 3440 G2	430
MTS8M 920 G2	115	MTS8M 1304 G2	163	MTS8M 1880 G2	235	MTS8M 3680 G2	460
MTS8M 928 G2	116	MTS8M 1312 G2	164	MTS8M 1912 G2	239	MTS8M 3720 G2	465
MTS8M 944 G2	118	MTS8M 1320 G2	165	MTS8M 1960 G2	245	MTS8M 3904 G2	488
MTS8M 952 G2	119	MTS8M 1352 G2	169	MTS8M 2000 G2	250	MTS8M 3928 G2	491
MTS8M 960 G2	120	MTS8M 1360 G2	170	MTS8M 2040 G2	255	MTS8M 4400 G2	550
MTS8M 976 G2	122	MTS8M 1384 G2	173	MTS8M 2048 G2	256		
MTS8M 984 G2	123	MTS8M 1400 G2	175	MTS8M 2064 G2	258		

MTS14M (Pitch 14 mm)

Product Code	No. of Teeth	Product Code	No. of Teeth	Product Code	No. of Teeth	Product Code	No. of Teeth
MTS14M 1008 G2	72	MTS14M 1708 G2	122	MTS14M 2198 G2	157	MTS14M 3360 G2	240
MTS14M 1120 G2	80	MTS14M 1736 G2	124	MTS14M 2240 G2	160	MTS14M 3500 G2	250
MTS14M 1190 G2	85	MTS14M 1750 G2	125	MTS14M 2310 G2	165	MTS14M 3556 G2	254
MTS14M 1246 G2	89	MTS14M 1778 G2	127	MTS14M 2380 G2	170	MTS14M 3850 G2	275
MTS14M 1288 G2	92	MTS14M 1806 G2	129	MTS14M 2450 G2	175	MTS14M 4004 G2	286
MTS14M 1400 G2	100	MTS14M 1890 G2	135	MTS14M 2506 G2	179	MTS14M 4508 G2	322
MTS14M 1470 G2	105	MTS14M 1932 G2	138	MTS14M 2590 G2	185	MTS14M 5012 G2	358
MTS14M 1540 G2	110	MTS14M 1960 G2	140	MTS14M 2660 G2	190		
MTS14M 1610 G2	115	MTS14M 2002 G2	143	MTS14M 2800 G2	200		
MTS14M 1652 G2	118	MTS14M 2100 G2	150	MTS14M 3150 G2	225		

MegaTorque EX

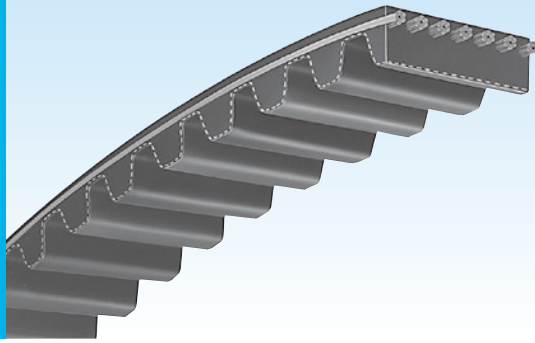

Characteristics and advantages of High Precision Positioning Timing Belt

- **Jumping resistance** By introducing extra high modulus cord, belt jumping torque extremely increase thus it prevent belt jumping against sudden acceleration and deceleration.
- **High damping characteristic** With using extra high modulus cord, damping characteristic is improved. It shorten the time for stopping the belt vibration and makes better accurate positioning efficiency.
- **High precision of positioning repeatability** Less stretch of the belt provides high accuracy of positioning repeatability. Belt positioning efficiency and repeatability extremely increase by using special pulley for minimum backlash.

● MTS3M

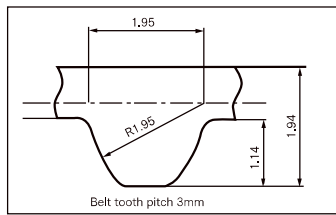

Standard Belt Width

Belt Width Code	Belt Width (mm)
60	6
100	10
150	15

100 | **MT** | **S3M** | **450** | **EX**
 Belt Width (mm)x10 | MEGA TORQUE | Belt Type | Belt Length (mm) | EX Specification

● MTS5M

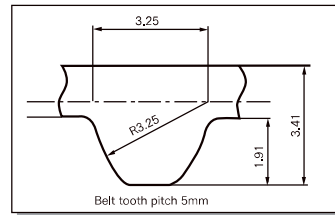

Standard Belt Width

Belt Width Code	Belt Width (mm)
100	10
150	15
250	25

100 | **MT** | **S5M** | **600** | **EX**
 Belt Width (mm)x10 | MEGA TORQUE | Belt Type | Belt Length (mm) | EX Specification

Standard Belt Sizes

MTS3M (Pitch 3 mm)			
Product Code	No. of Teeth	Product Code	No. of Teeth
MTS3M 240 EX	80	MTS3M 540 EX	180
MTS3M 270 EX	90	MTS3M 570 EX	190
MTS3M 300 EX	100	MTS3M 588 EX	196
MTS3M 324 EX	108	MTS3M 600 EX	200
MTS3M 330 EX	110	MTS3M 660 EX	220
MTS3M 360 EX	120	MTS3M 720 EX	240
MTS3M 390 EX	130	MTS3M 780 EX	260
MTS3M 420 EX	140	MTS3M 1035 EX	345
MTS3M 450 EX	150	MTS3M 1521 EX	507
MTS3M 480 EX	160	MTS3M 1788 EX	596
MTS3M 510 EX	170	MTS3M 2538 EX	846

Standard Belt Sizes

MTS5M (Pitch 5 mm)			
Product Code	No. of Teeth	Product Code	No. of Teeth
MTS5M 275 EX	55	MTS5M 690 EX	138
MTS5M 300 EX	60	MTS5M 700 EX	140
MTS5M 325 EX	65	MTS5M 720 EX	144
MTS5M 350 EX	70	MTS5M 750 EX	150
MTS5M 400 EX	80	MTS5M 800 EX	160
MTS5M 435 EX	87	MTS5M 850 EX	170
MTS5M 450 EX	90	MTS5M 880 EX	176
MTS5M 500 EX	100	MTS5M 900 EX	180
MTS5M 525 EX	105	MTS5M 950 EX	190
MTS5M 550 EX	110	MTS5M 1000 EX	200
MTS5M 575 EX	115	MTS5M 1780 EX	356
MTS5M 600 EX	120	MTS5M 3835 EX	767
MTS5M 650 EX	130		

GigaTorque GX

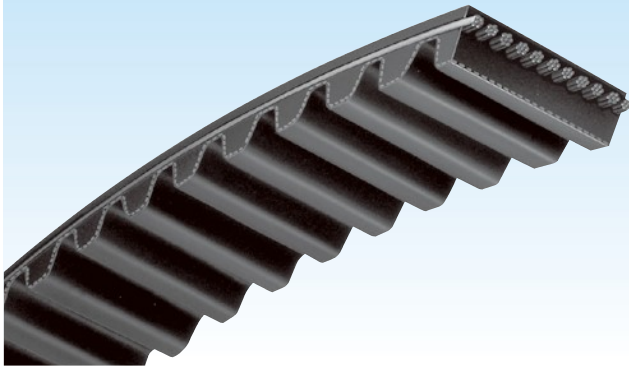

- Introducing high modulus but high flexibility carbon cord, this belt shows high tenacity and high flexibility.
- You may expect this belt to minimize space, weight and noise of machinery and equipment by applying narrower belt width compared to regular timing belt.
- This belt can be applied for the applicability of chain drive system.

Dimensions

- Tooth Shape & Product Code -

●G8M

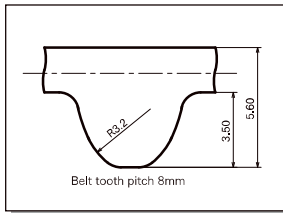

G8M Standard Belt Width

Belt Width(mm)	12	15	20	21	25	30	36	40	50	60	62	70	80
Belt Width Code	120	150	200	210	250	300	360	400	500	600	620	700	800

3 6 0 **G 8 M** **2 4 0 0** **G X**
 Nominal Width (mm × 10) Belt Type Nominal Length (mm) GX Spec.

●G14M

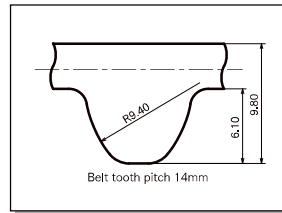

G14M Standard Belt Width

Belt Width(mm)	20	30	37	40	50	60	68	70	80	90	100	115	125	130
Belt Width Code	200	300	370	400	500	600	680	700	800	900	1000	1150	1250	1300

3 7 0 **G 1 4 M** **2 1 0 0** **G X**
 Nominal Width (mm × 10) Belt Type Nominal Length (mm) GX Spec.

Standard Belt Sizes

G8M			
Product Code	No. of Teeth	Product Code	No. of Teeth
G8M 640	80	G8M 2000	250
G8M 720	90	G8M 2200	275
G8M 800	100	G8M 2240	280
G8M 896	112	G8M 2400	300
G8M 960	120	G8M 2520	315
G8M 1000	125	G8M 2600	325
G8M 1040	130	G8M 2800	350
G8M 1120	140	G8M 2840	355
G8M 1200	150	G8M 3048	381
G8M 1224	153	G8M 3200	400
G8M 1280	160	G8M 3280	410
G8M 1440	180	G8M 3600	450
G8M 1600	200	G8M 4000	500
G8M 1760	220	G8M 4400	550
G8M 1792	224	G8M 4480	560

Standard Belt Sizes

G14M			
Product Code	No. of Teeth	Product Code	No. of Teeth
G14M 994	71	G14M 2450	175
G14M 1120	80	G14M 2520	180
G14M 1190	85	G14M 2590	185
G14M 1260	90	G14M 2660	190
G14M 1400	100	G14M 2800	200
G14M 1568	112	G14M 3136	224
G14M 1610	115	G14M 3304	236
G14M 1750	125	G14M 3360	240
G14M 1890	135	G14M 3500	250
G14M 1960	140	G14M 3850	275
G14M 2100	150	G14M 3920	280
G14M 2240	160	G14M 4326	309
G14M 2310	165	G14M 4410	315
G14M 2380	170		

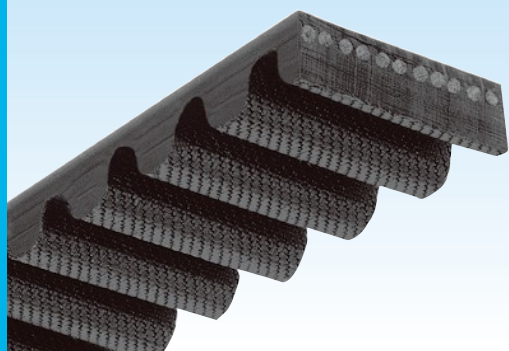

H Series

Round -shape belt teeth enable the distribution of load stress uniformly over the entire belt tooth. Since the belt tooth engages with the pulley groove without any interference, stress concentration at the root of the belt tooth can be eliminated. This belt can be used as an alternative for chains and gears with next advantages :

- High power trasmission capacity
- Long operative life
- Quiet operation
- Cost-efficiency

Dimensions

- Tooth Shape & Product Code -

●H8M

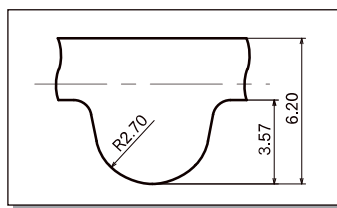

H8M Standard Belt Width

Belt Width (mm)	20.0	30.0	50.0	85.0
Belt Width Code	20	30	50	85

800 **H 8 M** **30**
 Belt Pitch Length Belt Type Belt Width

●H14M

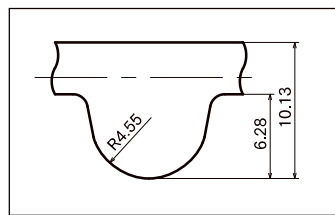

H14M Standard Belt Width

Belt Width (mm)	40.0	55.0	85.0	115.0
Belt Width Code	40	55	85	115

1610 **H 14 M** **40**
 Belt Pitch Length Belt Type Belt Width

The above mentioned shapes and figures are only for reference.

Standard Belt Sizes

H8M (Pitch 8 mm)			
Product Code	No. of Teeth	Product Code	No. of Teeth
424 H8M	53	1280 H8M	160
480 H8M	60	1304 H8M	163
536 H8M	67	1320 H8M	165
560 H8M	70	1360 H8M	170
592 H8M	74	1392 H8M	174
600 H8M	75	1400 H8M	175
624 H8M	78	1424 H8M	178
632 H8M	79	1432 H8M	179
640 H8M	80	1440 H8M	180
656 H8M	82	1480 H8M	185
680 H8M	85	1520 H8M	190
720 H8M	90	1600 H8M	200
760 H8M	95	1680 H8M	210
776 H8M	97	1696 H8M	212
800 H8M	100	1728 H8M	216
840 H8M	105	1760 H8M	220
856 H8M	107	1800 H8M	225
880 H8M	110	1896 H8M	237
896 H8M	112	1904 H8M	238
912 H8M	114	1936 H8M	242
920 H8M	115	2000 H8M	250
936 H8M	117	2080 H8M	260
960 H8M	120	2104 H8M	263
968 H8M	121	2160 H8M	270
1000 H8M	125	2240 H8M	280
1040 H8M	130	2272 H8M	284
1056 H8M	132	2400 H8M	300
1064 H8M	133	2504 H8M	313
1080 H8M	135	2600 H8M	325
1120 H8M	140	2800 H8M	350
1128 H8M	141	3048 H8M	381
1152 H8M	144	3200 H8M	400
1160 H8M	145	3280 H8M	410
1200 H8M	150	3600 H8M	450
1224 H8M	153		
1248 H8M	156		

Standard Belt Sizes

H14M (Pitch 14 mm)			
Product Code	No. of Teeth	Product Code	No. of Teeth
784 H14M	56	1736 H14M	124
826 H14M	59	1778 H14M	127
924 H14M	66	1890 H14M	135
966 H14M	69	1932 H14M	138
1148 H14M	82	1946 H14M	139
1190 H14M	85	2002 H14M	143
1344 H14M	96	2100 H14M	150
1400 H14M	100	2198 H14M	157
1456 H14M	104	2310 H14M	165
1512 H14M	108	2450 H14M	175
1540 H14M	110	2590 H14M	185
1568 H14M	112	2940 H14M	210
1610 H14M	115	3150 H14M	225
1638 H14M	117	3500 H14M	250
1652 H14M	118	4578 H14M	327
1680 H14M	120		

Trapezoidal Tooth Timing Belt

Belt Type, Dimensions & Product Code

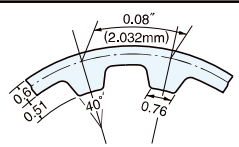
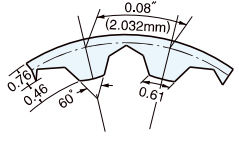
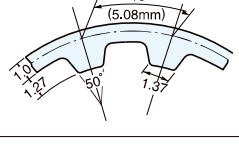
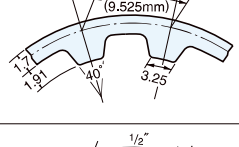
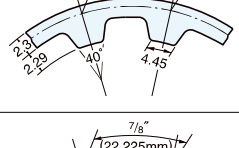
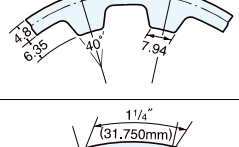
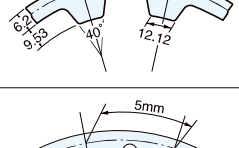
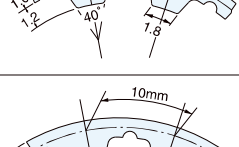
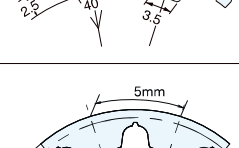
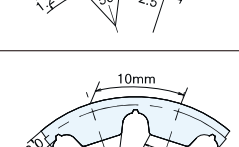
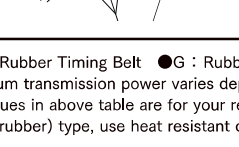
Belt Type	Standard Dimensions	Standard Width		Product Code	Minimum Pulley Size ¹		Applications
		Code	Width(mm)		Pulley Diameter(mm)	No. of teeth	
MXL (DMXL) GB		3.2 4.8 6.4 9.5 12.7	3.2 4.8 6.4 9.5 12.7	125 (D) MXL 6.4 No. of Teeth Double Type Belt Type Belt Width(mm)	6.47	10	Home sewing machine, typewriter, ATM, coin changer, cash register, printing machine, facsimile, measurement equipment, ticket machine, camera, paper feeder, printer, CPU peripherals, card reader, fish sonar finder, medical measurement equipment, radio-controlled model, audio player, VTR, editing equipment
T80 U		3.2 4.8 6.4 8.0 9.5	3.2 4.8 6.4 8.0 9.5	125 T80 6.4 No. of Teeth Belt Type Belt Width(mm)	6.47	10	Printer, copier, car antenna, projector
XL GB•U (DXL) GB		025 031 037 050	6.4 7.9 9.5 12.7	120 (D) XL 037 Belt Length (inch)×10 Double Type Belt Type Belt Width (inch)×100	16.17	10	Home sewing machine, line printer, medical bed, electrical shaver, auto door, copier, massage machine, editing machine, ticket machine, mower, food processor, calculator, fish sonar finder, blood pump, home meat slicer
L G•U (DL) G		050 075 100 150	12.7 19.1 25.4 38.1	510 (D) L 100 Belt Length (inch)×10 Double Type Belt Type Belt Width (inch)×100	36.38	12	Vending machine, wiper, packing machine, quenching machine, lift, ice crusher, industrial drier, automated golf cart, computer, copier, plastic lens polishing machine, food processing machine, seaweed collector
H (DH) G		075 100 150 200 300	19.1 25.4 38.1 50.8 76.2	510 (D) H 100 Belt Length (inch)×10 Double Type Belt Type Belt Width (inch)×100	56.60	14	Small milling machine, mower, power generator, compressor, scrap chopper, hole finishing machine, drilling machine, glass bottle making machine, food processing machines, rope coiler, roll coater, mill roll, woodworking machinery
XH G		200 300 400 500 600	50.8 76.2 101.6 127.0 152.4	1120 XH 300 Belt Length (inch)×10 Belt Type Belt Width (inch)×100	127.34	18	Saw mill, cutting machine, cutter, mixer, pump, welder, centrifuge, drilling machine, oscillating mill, lathe, wool loom, paper manufacturing machine, textile machine
XXH G		200 300 400 500 600	50.8 76.2 101.6 127.0 152.4	1200 XXH 300 Belt Length (inch)×10 Belt Type Belt Width (inch)×100	181.92	18	Blower, high pressure pump, change gear, rod mill, compressor, NC lathe, vibrator, mixer, abrasive boring machine
T5 (DT5) U		05 10 15 20	5.0 10.0 15.0 20.0	(D) T5 - 20 - 100 Double Type Belt Type No. of Teeth Belt Width(mm)	19.10	12	Data writer, facsimile, sewing machine
T10 (DT10) U		15 20 25 30 40 50	15.0 20.0 25.0 30.0 40.0 50.0	(D) T10 - 20 - 100 Double Type Belt Type No. of Teeth Belt Width(mm)	44.56	14	Packaging machine, card reader, textile machine, paper manufacturing machine, NC lathe, conveyor
AT5 U		10 20 30	10.0 20.0 30.0	AT5 - 20 - 975 Belt Type Belt Length(mm) Belt Width(mm)	19.10	12	Machine tools, pumps, textile machinery
AT10 U		10 20 30	10.0 20.0 30.0	AT10 - 20 - 1280 Belt Type Belt Length(mm) Belt Width(mm)	47.75	15	Construction machines, pumps, paper-making machines, compressors, textile machinery, sanding machines, machine tools, roller-table conveyor drives.

●GB : Bare Back Rubber Timing Belt ●G : Rubber Timing Belt ●U : Polyurethane Timing Belt

(Note) 1. Maximum transmission power varies depending on belt width and operating speed with the same belt.

The values in above table are for your reference. Please use correct values from relevant design catalog when you design.

2. For G (rubber) type, use heat resistant or oil resistant specification when the belts are used in high temperature (up to 120 °C) or where oil may contaminate the belts.

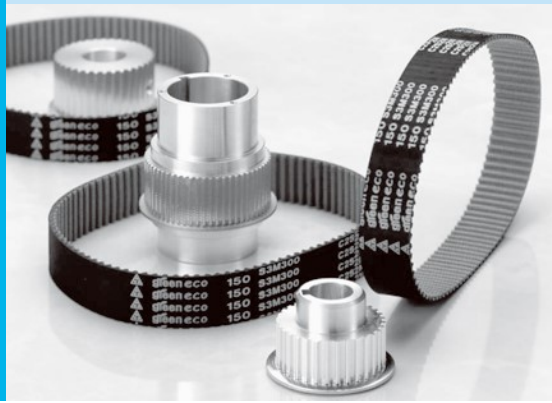

green eco® Series

Environmental-friendly rubber timing belts with EPDM compound rubber use.

- Excellent ozone resistance
- Less dispersion of rubber dust

Standard Dimensions and Product Code

Belt Type	Standard Dimensions	Product Code
MXL	<p>① 0.08" (2.032mm) ② 0.6mm ③ 0.51mm</p>	<p>125MXL12.7</p> <p>Belt Type</p> <p>No. of Teeth Belt Width (mm)</p>
S2M	<p>① 2.0mm ② 0.6mm ③ 0.76mm</p>	<p>40S2M160</p> <p>Belt Type</p> <p>Belt Width (mm) x10 Nominal Length (mm)</p>
S3M	<p>① 3.0mm ② 0.8mm ③ 1.14mm</p>	<p>100S3M459</p> <p>Belt Type</p> <p>Belt Width (mm) x10 Nominal Length (mm)</p>
S5M	<p>① 5.0mm ② 1.5mm ③ 1.91mm</p>	<p>250S5M1125</p> <p>Belt Type</p> <p>Belt Width (mm) x10 Nominal Length (mm)</p>

Timing Belt G

This synchronous transmission belt eliminates the problems of chains and gears.

Extra small pitch type fits well for precision equipment and IT systems.

- Thin, lightweight and superior flexibility of this belt allows compact design application.
- It enables efficient high speed power transmission
- Low noise operation compared to chain/gear use
- Cost-Efficient

Standard Belt Sizes

Belt Type	MXL													
	2.032(mm)													
	3.2(3.2 mm)			4.8(4.8 mm)			6.4(6.4 mm)			9.5(9.5 mm)			12.7(12.7mm)	
Tooth Pich														
Code(Width)	Product Code	No.of Teeth	Belt Pich Length(mm)	Product Code	No.of Teeth	Belt Pich Length(mm)	Product Code	No.of Teeth	Belt Pich Length(mm)	Product Code	No.of Teeth	Belt Pich Length(mm)		
Size	34 MXL	34	69,09	112 MXL	112	227,58	(D)230 MXL	230	467,36	(D)438 MXL	438	890,02		
	35 MXL	35	71,12	114 MXL	114	231,65	(D)232 MXL	232	471,42	(D)448 MXL	448	910,34		
	40 MXL	40	81,28	115 MXL	115	233,68	(D)236 MXL	236	479,55	(D)453 MXL	453	920,50		
	41 MXL	41	83,31	118 MXL	118	239,78	(D)239 MXL	239	485,65	(D)464 MXL	464	942,85		
	45 MXL	45	91,44	120 MXL	120	243,84	(D)240 MXL	240	487,68	(D)475 MXL	475	965,20		
	46 MXL	46	93,47	121 MXL	121	245,87	(D)245 MXL	245	497,84	(D)478 MXL	478	971,30		
	48 MXL	48	97,54	122 MXL	122	247,90	(D)248 MXL	248	503,94	(D)487 MXL	487	989,58		
	49 MXL	49	99,57	123 MXL	123	249,94	(D)250 MXL	250	508,00	(D)498 MXL	498	1011,94		
	50 MXL	50	101,60	125 MXL	125	254,00	(D)256 MXL	256	520,19	(D)500 MXL	500	1016,00		
	52 MXL	52	105,66	126 MXL	126	256,03	(D)260 MXL	260	528,32	503 MXL	503	1022,10		
	53 MXL	53	107,70	127 MXL	127	258,06	(D)262 MXL	262	532,38	(D)507 MXL	507	1030,22		
	54 MXL	54	109,73	128 MXL	128	260,10	(D)265 MXL	265	538,48	(D)515 MXL	515	1046,48		
	55 MXL	55	111,76	130 MXL	130	264,16	(D)270 MXL	270	548,64	(D)516 MXL	516	1048,51		
	56 MXL	56	113,79	131 MXL	131	266,19	(D)273 MXL	273	554,74	(D)520 MXL	520	1056,64		
	57 MXL	57	115,82	132 MXL	132	268,22	(D)275 MXL	275	558,80	(D)525 MXL	525	1066,80		
	59 MXL	59	119,89	134 MXL	134	272,29	(D)278 MXL	278	564,90	(D)535 MXL	535	1087,12		
	60 MXL	60	121,92	135 MXL	135	274,32	(D)280 MXL	280	568,96	(D)537 MXL	537	1091,18		
	61 MXL	61	123,95	138 MXL	138	280,42	(D)281 MXL	281	570,99	548 MXL	548	1113,54		
	63 MXL	63	128,02	140 MXL	140	284,48	(D)285 MXL	285	579,12	(D)550 MXL	550	1117,60		
	65 MXL	65	132,08	142 MXL	142	288,54	(D)288 MXL	288	585,22	(D)569 MXL	569	1156,21		
	66 MXL	66	134,11	144 MXL	144	292,61	(D)290 MXL	290	589,28	(D)591 MXL	591	1200,91		
	67 MXL	67	136,14	(D)145 MXL	145	294,64	(D)295 MXL	295	599,44	(D)650 MXL	650	1320,80		
	68 MXL	68	138,18	(D)146 MXL	146	296,67	(D)297 MXL	297	603,50	(D)705 MXL	705	1432,56		
	70 MXL	70	142,24	(D)147 MXL	147	298,70	(D)300 MXL	300	609,60	(D)772 MXL	772	1568,70		
	71 MXL	71	144,27	(D)148 MXL	148	300,74	(D)305 MXL	305	619,76	1369 MXL	1369	2781,81		
	72 MXL	72	146,30	(D)150 MXL	150	304,80	(D)310 MXL	310	629,92					
	73 MXL	73	148,34	(D)152 MXL	152	308,86	(D)312 MXL	312	633,98					
	74 MXL	74	150,37	(D)154 MXL	154	312,93	(D)315 MXL	315	640,08					
	75 MXL	75	152,40	(D)155 MXL	155	314,96	(D)318 MXL	318	646,18					
	76 MXL	76	154,43	(D)156 MXL	156	316,99	(D)320 MXL	320	650,24					
	77 MXL	77	156,46	(D)158 MXL	158	321,06	(D)324 MXL	324	658,37					
	78 MXL	78	158,50	(D)160 MXL	160	325,12	(D)330 MXL	330	670,56					
	79 MXL	79	160,53	(D)162 MXL	162	329,18	(D)332 MXL	332	674,62					
	80 MXL	80	162,56	(D)165 MXL	165	335,28	(D)334 MXL	334	678,69					
	81 MXL	81	164,59	(D)170 MXL	170	345,44	(D)336 MXL	336	682,75					
	82 MXL	82	166,62	(D)171 MXL	171	347,47	(D)337 MXL	337	684,78					
	83 MXL	83	168,66	(D)175 MXL	175	355,60	(D)338 MXL	338	686,82					
	85 MXL	85	172,72	(D)184 MXL	184	373,89	(D)339 MXL	339	688,85					
	86 MXL	86	174,75	(D)185 MXL	185	375,92	344 MXL	344	699,01					
	87 MXL	87	176,78	(D)186 MXL	186	377,95	(D)347 MXL	347	705,10					
	88 MXL	88	178,82	(D)187 MXL	187	379,98	(D)348 MXL	348	707,14					
	89 MXL	89	180,85	(D)188 MXL	188	382,02	(D)350 MXL	350	711,20					
	90 MXL	90	182,88	(D)190 MXL	190	386,08	(D)355 MXL	355	721,36					
	91 MXL	91	184,91	(D)192 MXL	192	390,14	(D)359 MXL	359	729,49					
	92 MXL	92	186,94	(D)194 MXL	194	394,21	(D)364 MXL	364	739,65					
	93 MXL	93	188,98	(D)195 MXL	195	396,24	(D)365 MXL	365	741,68					
	94 MXL	94	191,01	(D)198 MXL	198	402,34	(D)367 MXL	367	745,74					
	95 MXL	95	193,04	(D)200 MXL	200	406,40	(D)372 MXL	372	755,90					
	96 MXL	96	195,07	(D)203 MXL	203	412,50	(D)380 MXL	380	772,16					
	97 MXL	97	197,10	(D)205 MXL	205	416,56	(D)386 MXL	386	784,35					
	98 MXL	98	199,14	(D)210 MXL	210	426,72	(D)397 MXL	397	806,70					
	100 MXL	100	203,20	(D)212 MXL	212	430,78	(D)400 MXL	400	812,80					
	101 MXL	101	205,23	(D)219 MXL	219	445,01	(D)405 MXL	405	822,96					
	102 MXL	102	207,26	(D)220 MXL	220	447,04	(D)411 MXL	411	835,15					
	103 MXL	103	209,30	(D)221 MXL	221	449,07	(D)415 MXL	415	843,28					
	105 MXL	105	213,36	(D)222 MXL	222	451,10	(D)419 MXL	419	851,41					
	106 MXL	106	215,39	(D)224 MXL	224	455,17	(D)420 MXL	420	853,44					
	108 MXL	108	219,46	(D)226 MXL	226	459,23	(D)424 MXL	424	861,57					
	109 MXL	109	221,49	(D)227 MXL	227	461,26	(D)435 MXL	435	883,92					
	110 MXL	110	223,52	(D)228 MXL	228	463,30	(D)436 MXL	436	885,95					

- This belt is usually made-to-order, however please check with us for stock when you place order.
- (D) signifies standard size of double timing belt G (rubber) type.

Timing Belt G

Standard Belt Sizes

Belt Type	XH			XXH		
Tooth Pitch	22.225 (mm)			31.750 (mm)		
Code(Width)	200 (50.8 mm) 300 (76.2 mm) 400 (101.6 mm) 500 (127.0 mm) 600 (152.4 mm)			200 (50.8 mm) 300 (76.2 mm) 400 (101.6 mm) 500 (127.0 mm) 600 (152.4 mm)		
Size	Product Code	No.of Teeth	Belt Pitch Length(mm)	Product Code	No.of Teeth	Belt Pitch Length(mm)
	463 XH	53	1177.93	700 XXH	56	1778.00
	507 XH	58	1289.05	800 XXH	64	2032.00
	560 XH	64	1422.40	900 XXH	72	2286.00
	630 XH	72	1600.20	1000 XXH	80	2540.00
	700 XH	80	1778.00	1200 XXH	96	3048.00
	735 XH	84	1866.90	1400 XXH	112	3556.00
	770 XH	88	1955.80	1600 XXH	128	4064.00
	840 XH	96	2133.60	1800 XXH	144	4572.00
	927 XH	106	2355.85			
	980 XH	112	2489.20			
	1120 XH	128	2844.80			
	1260 XH	144	3200.40			
	1400 XH	160	3556.00			
	1540 XH	176	3911.60			
	1750 XH	200	4445.00			