

# tend INSULATED ENCLOSURES(TN2 Ø22)

TN2

The mounting holes of this series of insulated enclosures are Ø22mm. single-hole insulated enclosure is available in yellow and gray. All the others are in gray. The contact blocks are of exclusive type, which is different from those of Ø22/Ø30 series control components. The dimension and type of the upper base are same as those of Ø22/Ø30 series control components.

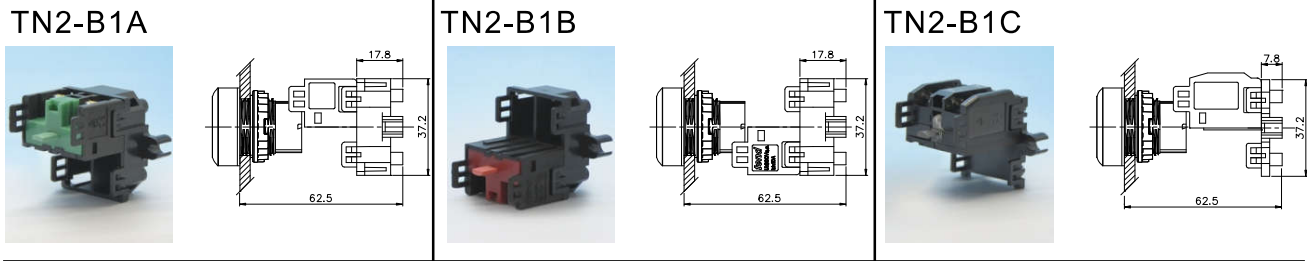

## THE ASSEMBLY OF INSULATED ENCLOSURES AND SWITCH

1. Take apart the upper cover and the lower base of the insulated enclosures.
  2. Fix the contact block on the lower base, and the upper base on the upper cover.
  3. Connect the upper cover with the lower base into one kit.
- The protection structure for this series of insulated enclosures is IP65(IEC144)
  - All the illuminated switches used in the insulated enclosures are direct type

## STANDARD CONTACT BLOCK FOR INSULATED ENCLOSURES ■ ILLUMINATED CONTACT BLOCK FOR INSULATED ENCLOSURES

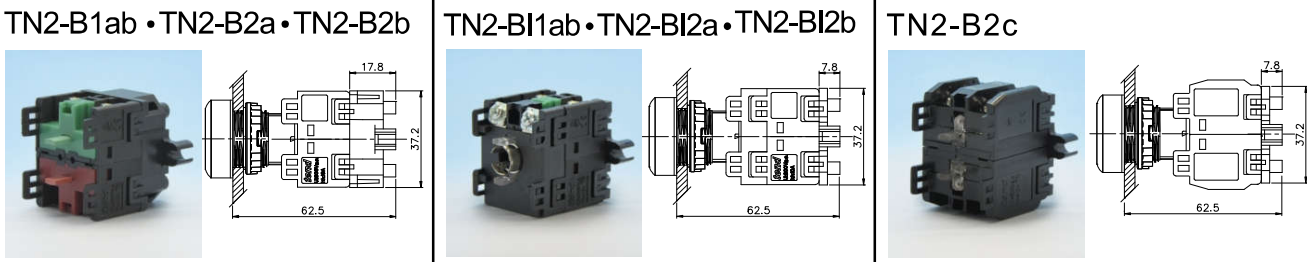

## LAMP HOLDER BLOCKS(FOR INSULATED ENCLOSURES) ■ CABLE GLAND TPF-21

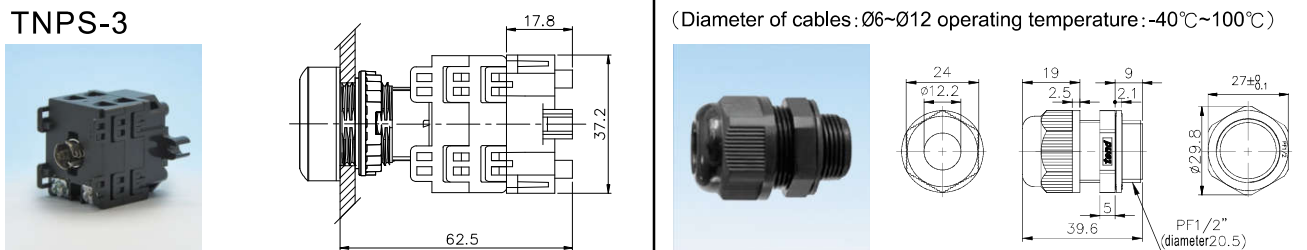

## INSULATED ENCLOSURES DIMENSIONS TN2:Ø22mm TN3:Ø30mm

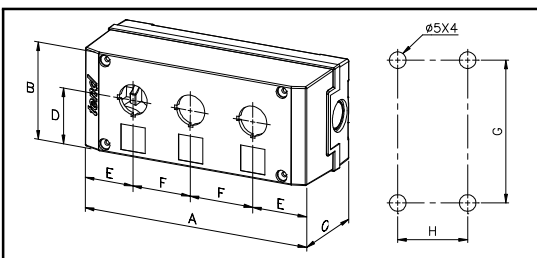

Type	A	B	C	D	E	F	G	H
TN2-B1 TN3-B1	82	75	67.3	43.5	41	—	63	54
TN2-B2 TN3-B2	127	75	67.3	43.5	41	45	108	54
TN2-B3 TN3-B3	172	75	67.3	43.5	41	45	153	54
TN2-B4 TN3-B4	217	75	67.3	43.5	41	45	198	54
TN2-B5 TN3-B5	262	75	67.3	43.5	41	45	243	54