

COPPER TUBE TERMINAL

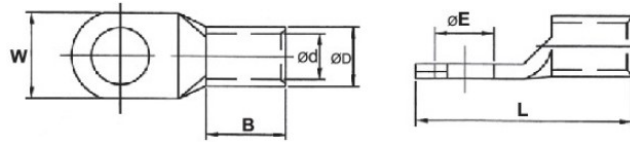

- TERMINAL MATERIAL : COPPER TUBULAR



- Manufactured from soft drawn pure copper tube to JIS-H3300, C 1020T-0 (Oxygen-Free Copper) which gives the product with best quality.
- Complete range terminals, ranging from 1.5mm² to 630mm² with cable inspection hole.

ITEM NO.	CABLE SQ.	STUD HOLD SIZE ØE	DIMENSIONS				L	ITEM NO.	CABLE SQ.	STUD HOLD SIZE ØE	DIMENSIONS				L
			ØD	Ød	W	B					ØD	Ød	W	B	
SC1.5-4	1.5	4.2	3.7	1.8	8.0	5	16	SC25-8	25	8.4	8.8	6.8	15.0	12	33
SC1.5-5		5.2	3.7	1.8	10.0	5	17	SC25-10		10.5	8.8	6.8	18.0	12	34
SC1.5-6		6.5	3.7	1.8	10.0	5	18	SC25-12		13.0	8.8	6.8	18.0	12	35
SC2.5-4	2.5	4.2	4.0	2.4	8.0	7	18	SC25-14		15.0	8.8	6.8	20.0	12	38
SC2.5-5		5.2	4.0	2.4	10.0	7	20	SC35-5	35	5.2	10.6	8.2	16.0	14	38
SC2.5-6		6.5	4.0	2.4	10.0	7	20	SC35-6		6.5	10.6	8.2	16.0	14	38
SC2.5-8	8.4	4.0	2.4	12.5	7	23	SC35-8	8.4		10.6	8.2	16.0	14	38	
SC4-4	4	4.2	4.8	3.1	10.0	7	20	SC35-10		10.5	10.6	8.2	18.0	14	39
SC4-5		5.2	4.8	3.1	10.0	7	20	SC35-12		13.0	10.6	8.2	19.0	14	40.5
SC4-6		6.5	4.8	3.1	10.0	7	20	SC35-14	15.0	10.6	8.2	20.0	14	42	
SC4-8		8.4	4.8	3.1	12.5	7	23	SC50-6	50	6.5	12.4	9.5	17.8	16	45
SC6-4	6	4.2	5.5	3.8	10.0	9	23	SC50-8		8.4	12.4	9.5	17.8	16	45
SC6-5		5.2	5.5	3.8	10.0	9	24	SC50-10		10.5	12.4	9.5	17.8	16	45
SC6-6		6.5	5.5	3.8	12.0	9	24	SC50-12		13.0	12.4	9.5	20.0	16	45
SC6-8		8.4	5.5	3.8	12.5	9	26	SC50-14		15.0	12.4	9.5	22.0	16	46
SC6-10		10.5	5.5	3.8	15.0	9	28	SC50-16		17.0	12.4	9.5	24.0	16	47
SC10-5		10	5.2	6.2	4.5	12.0	9	25	SC70-8	70	8.4	14.7	11.2	21.0	20
SC10-6	6.5		6.2	4.5	12.0	9	25	SC70-10	10.5		14.7	11.2	21.0	20	52
SC10-8	8.4		6.2	4.5	12.5	9	27	SC70-12	13.0		14.7	11.2	21.0	20	52
SC10-10	10.5		6.2	4.5	15.0	9	29	SC70-14	15.0		14.7	11.2	21.0	20	52
SC10-12	13.0		6.2	4.5	17.0	9	31	SC70-16	17.0		14.7	11.2	25.0	20	53
SC16-5	16	5.2	7.1	5.4	12.0	12	30	SC95-8	95	8.4	17.4	13.5	25.0	23	58
SC16-6		6.5	7.1	5.4	12.0	12	30	SC95-10		10.5	17.4	13.5	25.0	23	58
SC16-8		8.4	7.1	5.4	12.5	12	30	SC95-12		13.0	17.4	13.5	25.0	23	58
SC16-10		10.5	7.1	5.4	16.0	12	33	SC95-14		15.0	17.4	13.5	25.0	23	58
SC16-12		13.0	7.1	5.4	17.0	12	35	SC95-16		17.0	17.4	13.5	25.0	23	58
SC20-8	20	8.4	8.3	6.3	13.0	12	32	SC120-8	120	8.4	19.4	15.0	28.0	22	63
SC25-5	25	5.2	8.8	6.8	13.0	12	33	SC120-10		10.5	19.4	15.0	28.0	22	63
SC25-6		6.5	8.8	6.8	13.0	12	33	SC120-12		13.0	19.4	15.0	28.0	22	63
								SC120-14		15.0	19.4	15.0	28.0	22	63

ITEM NO.	CABLE SQ.	STUD HOLD SIZE	DIMENSIONS				
			øE	øD	ød	W	B
SC120-16	120	17.0	19.4	15.0	28.0	22	63
SC120-20		21.0	19.4	15.0	28.0	22	63
SC150-8	150	8.4	21.2	16.5	30.5	26	70
SC150-10		10.5	21.2	16.5	30.5	26	70
SC150-12		13.0	21.2	16.5	30.5	26	70
SC150-14		15.0	21.2	16.5	30.5	26	70
SC150-16		17.0	21.2	16.5	30.5	26	70
SC150-20		21.0	21.2	16.5	30.5	26	70
SC185-10	185	10.5	23.5	18.5	34.0	32	75
SC185-12		13.0	23.5	18.5	34.0	32	75
SC185-14		15.0	23.5	18.5	34.0	32	75
SC185-16		17.0	23.5	18.5	34.0	32	75
SC185-20		21.0	23.5	18.5	34.0	32	75
SC240-10		240	10.5	26.5	21.0	38.5	38
SC240-12	13.0		26.5	21.0	38.5	38	90
SC240-14	15.0		26.5	21.0	38.5	38	90
SC240-16	17.0		26.5	21.0	38.5	38	90
SC240-20	21.0		26.5	21.0	38.5	38	90
SC300-10	300		10.5	30.0	23.5	43.0	42
SC300-12		13.0	30.0	23.5	43.0	42	98

ITEM NO.	CABLE SQ.	STUD HOLD SIZE	DIMENSIONS				
			øE	øD	ød	W	B
SC300-14	300	15.0	30.0	23.5	43.0	42	98
SC300-16		17.0	30.0	23.5	43.0	42	98
SC300-20		21.0	30.0	23.5	43.0	42	98
SC400-10	400	10.5	36.5	28.5	52.0	44	110
SC400-12		13.0	36.5	28.5	52.0	44	110
SC400-14		15.0	36.5	28.5	52.0	44	110
SC400-16		17.0	36.5	28.5	52.0	44	110
SC400-20		21.0	36.5	28.5	52.0	44	110
SC500-10		500	10.5	39.0	30.0	56.0	48
SC500-12	13.0		39.0	30.0	56.0	48	120
SC500-14	15.0		39.0	30.0	56.0	48	120
SC500-16	17.0		39.0	30.0	56.0	48	120
SC500-20	21.0		39.0	30.0	56.0	48	120
SC630-10	630		10.5	45.0	35.0	65.0	56
SC630-12		13.0	45.0	35.0	65.0	56	140
SC630-14		15.0	45.0	35.0	65.0	56	140
SC630-16		17.0	45.0	35.0	65.0	56	140
SC630-20		21.0	45.0	35.0	65.0	56	140