

MS1003Z-1-1



目录
Category

A拉手系列
Handles
series

B平面锁系列
Plane lock
series

C连杆锁系列
Rod control
series

D面板锁系列
Plane lock
series

E执手锁系列
Handle lock
series

F转舌锁系列
Cam lock
series

G铰链系列
Hinge
series

H搭扣锁系列
Toggle lock
series

I门销系列
Door bolt
series

J电子锁系列
Electronic
lock series

K密封条系列
Gasketing
series

L限位系列
Door stop
series

M附件系列
Accessories
series

N不锈钢系列
Stainless steel
series

索引
Index



- 材质: 锌合金手柄, 不锈钢锁壳, 铜片, 螺母
- 表面处理: 手柄喷光亮黑
- 适用门板厚度: 1-5
- 备注: 锁片开孔: 8X8
- Material: zinc die-casting handle, stainless steel housing, cam and nut.
- Finish: black powder coated for the handle.
- Panel thickness: 1-5mm.
- Remark: 8X8 cut out

手柄型转舌锁 Handle Type Handle Lock

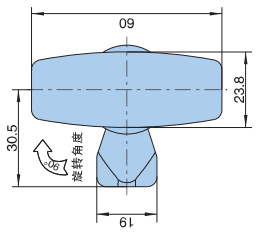
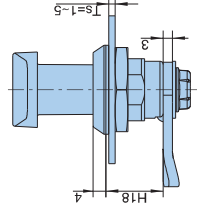

■ 开孔尺寸
Cut Out

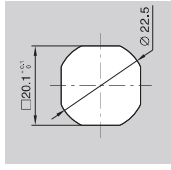

| 型号 Product no. | 产品重量(g) Weight | 装箱数 Lot |
|-------------------|-------------------|------------|
| MS1003Z-1-1 | 136.3 | 180 |

手柄型转舌锁 Handle Type Handle Lock

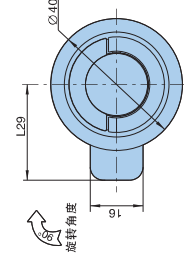
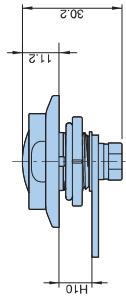

■ 开孔尺寸
Cut Out

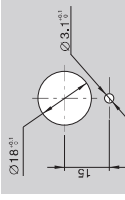

| 型号 Product no. | 产品重量(g) Weight | 装箱数 Lot |
|-------------------|-------------------|------------|
| MS1003Z-1-2 | 78 | 400 |

- 材质: 锌合金锁体、螺母、镀锌铜片
- 表面处理: 镀亮铬
- 适用门板厚度: 1-3mm
- Material: Zinc die-casting body, Nut, Zinc plating cam
- Finish: Bright chrome plating
- Panel thickness: 1-3mm

手柄型转舌锁 Handle Type Handle Lock

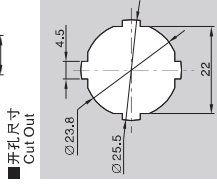
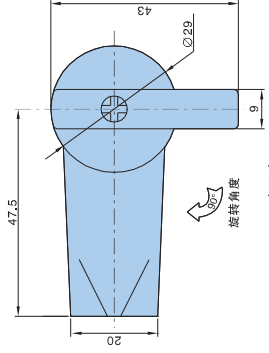

■ 开孔尺寸
Cut Out

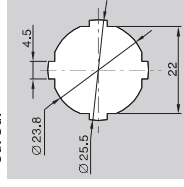

| 型号 Product no. | 产品重量(g) Weight | 装箱数 Lot |
|-------------------|-------------------|------------|
| MS406 | 83 | 200 |

- 材质: ABS执手, 锌合金锁体、螺母、镀锌铜片
- 表面处理: 黑
- 适用门板厚度: 1-7mm
- Material: ABS knob, zinc die-casting body, nut, Zinc plating cam
- Finish: black
- Panel thickness: 1-7mm

手柄型转舌锁 Handle Type Handle Lock

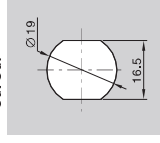
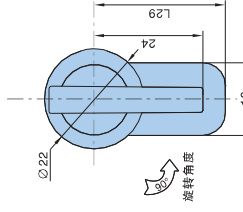

■ 开孔尺寸
Cut Out

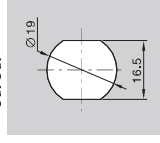

| 型号 Product no. | 产品重量(g) Weight | 装箱数 Lot |
|-------------------|-------------------|------------|
| MS412 | 73 | 300 |

- 材质: 锌合金锁体、螺母、镀锌铜片
- 表面处理: 镀锌珠镍
- 适用门板厚度: 1-20mm
- Material: Zinc die-casting body, Nut, Zinc plating cam, washer
- Finish: Nickel plating
- Panel thickness: 1-20mm

MS406



MS412

