

Pressure Gauge for General Purpose (DT type)

G43 Series

RoHS



G43-10-01

- Be sure to read the precautions on page 891 for selection and mounting.

Standard Specifications

Model		G43
Type		Back side thread
Port size ⁽¹⁾		R 1/8, R 1/4
Fluid ⁽²⁾		Air
Indication precision ⁽³⁾		±3% F.S. (Full span)
Material	Case	Stainless steel
	Clear cover	Glass
	Stud	Brass
	Bourdon tube	Brass
Weight [kg]		0.07
Applicable model		IP200, IP8000, IR2000, IR3000, IT2000, IT4000

Note 1) When mounting a pressure gauge, use caution not to tighten excessively. Excessive tightening will cause product to be damaged. Use a pipe tape for sealing.

Note 2) Avoid freezing as this may cause a malfunction.

Note 3) The guaranteed temperature range is 23°C ±5°C.

Model (Standard)

Model	Pressure range ⁽¹⁾	Indication unit	Connection thread	Note
	MPa			
G43-2-01 to 02	0 to 0.2	MPa	R 1/8, R 1/4	—
G43-4-01 to 02	0 to 0.4		R 1/8	
G43-6-01	0 to 0.6			
G43-7-01 to 02	0 to 0.7			
G43-10-01 to 02	0 to 1.0			

Note 1) Do not apply pressure more than the maximum display pressure. This will cause a malfunction.

Model (Made to Order)

Model	Pressure range ⁽¹⁾	Indication unit	Connection thread	Note	
	MPa				
G43-2-01 to 02-X2	0 to 0.2	MPa	R 1/8, R 1/4	X2: Stud parts nickle plated	
G43-4-01 to 02-X2	0 to 0.4		R 1/8		
G43-6-01-X2	0 to 0.6				
G43-7-01 to 02-X2	0 to 0.7				
G43-10-01 to 02-X2	0 to 1.0		R 1/8, R 1/4		
G43-2-01 to 02-X3	0 to 0.2		R 1/8, R 1/4	X3: Wetted parts stainless steel	
G43-4-01 to 02-X3	0 to 0.4				R 1/8
G43-6-01-X3	0 to 0.6				
G43-7-01 to 02-X3	0 to 0.7				
G43-10-01 to 02-X3	0 to 1.0		R 1/8, R 1/4		
G43-2-01-X4	0 to 0.2		R 1/8	X4: Oil-free (Wetted parts degreasing)	
G43-4-01 to 02-X4	0 to 0.4				R 1/8, R 1/4
G43-7-01 to 02-X4	0 to 0.7				
G43-10-01 to 02-X4	0 to 1.0				

Note 1) Do not apply pressure more than the maximum display pressure. This will cause a malfunction.

How to Order

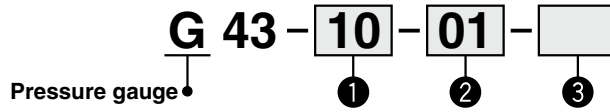

	Symbol	Description	G43
		+	
① Max. display pressure	2	0.2 MPa	●
	3	0.3 MPa	●
	4	0.4 MPa	●
	6	0.6 MPa	●
	7	0.7 MPa	●
	10	1.0 MPa	●
	P2 ⁽¹⁾	0.2 MPa, 30 psi	○ ⁽²⁾
	P4 ⁽¹⁾	0.4 MPa, 60 psi	○ ⁽²⁾
	P6 ⁽¹⁾	0.6 MPa, 90 psi	○ ⁽²⁾
	P7 ⁽¹⁾	0.7 MPa, 100 psi	○ ⁽²⁾
P10 ⁽¹⁾	1.0 MPa, 150 psi	○ ⁽²⁾	
		+	
② Connection thread	01	R 1/8	●
	02	R 1/4	●
		+	
③ Special specification	Nil	—	●
	X2	Stud parts nickel plated	●
	X3 ⁽³⁾	Wetted parts stainless steel	●
	X4	Oil-free (Wetted parts degrease washing)	●
	X30	Both MPa and psi	○ ⁽²⁾

Note 1) This symbol must be used with Special specification "X30."
 Note 2) Under the New Measurement Law, products for overseas use only (SI unit type for use in Japan)
 Note 3) Movable parts (gear, etc.) inside pressure gauge are made of brass.
 Note 4) Cover ring assembly is not available.

Dimensions (Except Made-to-Order products)

G43-□-01 to 02

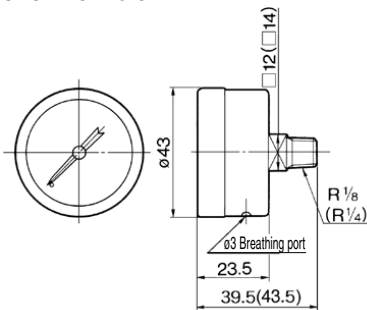

* The dimensions in (): Connection thread R 1/4

