



Deep Socket

2230M

1/4"

- DIN 3124, ISO 2725-1

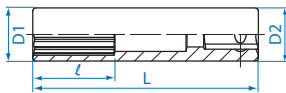

KT NO.	Size mm	D1 mm	D2 mm	l mm	L mm		
223004M	4	6.8	11.8	6	50	20	20 / 32
223045M	4.5	7.4	11.8	7	50	20	20 / 320
223005M	5	8.0	11				
223055M	5.5	8.7	11.8	9	50	20	20 / 32
223006M	6	9.2	11.8	9	50	21	20 / 320
223007M	7	10.3	11.8	15	50	22	20 / 320
223008M	8	11.8	11.8	15	50	25	20 / 320
223009M	9	13.0	13.0	15	50	28	15 / 240
223010M	10	14.5	14.5	15	50	36	15 / 240
223011M	11	15.8	15.8	21	50	41	15 / 240
223012M	12	16.8	16.8	21	50	47	15 / 240
223013M	13	17.8	17.8	21	50	49	15 / 240
223014M	14	19.8	19.8	21	50	66	15 / 240

Double Square Socket

2310M

2310S

1/4"

- Metric-DIN 3120
- Inch-ANSI / ASME B107.1

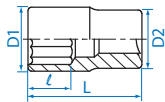

KT NO.	Size mm	D1 mm	D2 mm	l mm	L mm		
231008M	8	13.8	13.0	9	24	16	12 / 360
231010M	10	16.8	15.4	9	24	22	12 / 360
KT NO.	Size inch	D1 mm	D2 mm	l mm	L mm		
231010S	5/16	13.8	13.0	9	24	15	12 / 36
231012S	3/8	16.8	15.4	9	24	24	12 / 360

Star Socket

2375M

1/4"

- DIN 3120

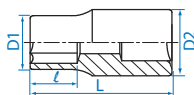

KT NO.	Size	D1 mm	D2 mm	l mm	L mm		
237504M	E4	6.0	11.8	3.6	24	9	20 / 600
237505M	E5	7.0	11.8	4.0	24	10	20 / 600
237506M	E6	8.0	11.8	6.0	24	10	20 / 600
237507M	E7	8.5	11.8	7.0	24	11	20 / 600
237508M	E8	9.8	11.8	8.0	24	11	20 / 600
237510M	E10	11.8	11.8	9.0	24	13	20 / 600

Star Socket

2275M

1/4"

- DIN 3120

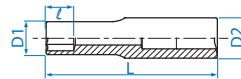

KT NO.	Size	D1 mm	D2 mm	l mm	L mm		
227504M	E4	6.0	11.8	3.6	50	21	20 / 320
227505M	E5	7.0	11.8	4.0	50	22	20 / 320
227506M	E6	8.0	11.8	6.0	50	24	20 / 320
227507M	E7	8.5	11.8	7.0	50	24	20 / 320
227508M	E8	9.8	11.8	8.0	50	26	20 / 320

Bit Socket



In order to get normal life of bit socket, always use within limited torque to bit.

2011X

1/4"

- Phillips head
- DIN ISO 8764-1

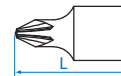

KT NO.	Size No.	L mm		
201101X	PH1	25	9	20 / 600
201102X	PH2	25	9	20 / 6
201103X	PH3	25	10	20 / 600
201104X	PH4	25	12	20 / 600

2012X

1/4"

- Slotted head
- DIN ISO 2380-1

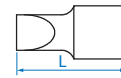

KT NO.	Tip width mm	Tip thickness mm	L mm		
201235X	3.5	0.6	25	8	20 / 6
201255X	5.5	1.0	25	9	20 / 6
201208X	8	1.2	25	10	20 / 60

2015X

1/4"

- Hexagon head
- DIN ISO 2380-1

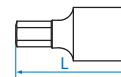

KT NO.	Size mm	L mm		
201503MX	H3	25	8	20 / 600
201504MX	H4	25	9	20 / 600
201505MX	H5	25	10	20 / 600
201506MX	H6	25	10	20 / 600
201508MX	H8	25	13	20 / 600
201510MX	H10	25	15	20 / 600
201504SX	1/8	25	8	20 / 60
201506SX	3/16	25	9	20 / 60
201507SX	7/32	25	10	20 / 600
201508SX	1/4	25	10	20 / 600
201510SX	5/16	25	13	20 / 600
201512SX	3/8	25	14	20 / 600

Bit Socket

KT No. & D1



2013X

1/4"

- For torx internal screw



KT NO.	Size	L mm	Weight	Packaging
201308X	T8	25	8	20 / 60
201309X	T9	25	8	20 / 60
201310X	T10	25	8	20 / 60
201315X	T15	25	8	20 / 6
201320X	T20	25	9	20 / 60
201325X	T25	25	9	20 / 60
201327X	T27	25	9	20 / 600
201330X	T30	25	10	20 / 600
201340X	T40	25	11	20 / 600

2018X

1/4"

- Pozidriv head
- DIN ISO 8764-1



KT NO.	No.	L mm	Weight	Packaging
201801X	PZ1	25	9	20 / 600
201802X	PZ2	25	9	20 / 600
201803X	PZ3	25	10	20 / 600
201804X	PZ4	25	11	20 / 600

2031

1/4"

- Phillips head
- DIN ISO 8764-1



KT NO.	No.	L mm	Weight	Packaging
203101	PH1	37	15	20 / 600
203102	PH2	37	15	20 / 600
203103	PH3	37	15	20 / 600
203104	PH4	37	16	20 / 600

2032

1/4"

- Slotted head
- DIN ISO 8764-1



KT NO.	Tip width mm	Tip thickness mm	L mm	Weight	Packaging
203235	3.5	0.5	37	15	20 / 600
203204	4	0.8	37	14	20 /
203255	5.5	1.0	37	15	20 / 600
203265	6.5	1.2	37	15	20 / 600
203207	7	1.2	37	15	20 / 600
203208	8	1.2	37	16	20 / 600
203210	10	1.6	37	20	20 / 600

2035

1/4"

- Hexagon head
- DIN 7422 / 3120



KT NO.	mm	L mm	Weight	Packaging
203503	H3	37	15	20 / 600
203504	H4	37	15	20 / 600
203505	H5	37	15	20 / 600
203506	H6	37	16	20 / 600
203507	H7	37	18	20 / 600
203508	H8	37	19	20 / 600
203510	H10	37	23	20 / 600

2033

1/4"

- For torx internal screw
- DIN 3120



KT NO.	Size	L mm	Weight	Packaging
203308	T8	37	14	20 / 600
203309	T9	37	14	20 / 600
203310	T10	37	14	20 / 600
203315	T15	37	14	20 / 600
203320	T20	37	15	20 / 600
203325	T25	37	15	20 / 600
203327	T27	37	15	20 / 600
203330	T30	37	16	20 / 600
203340	T40	37	16	20 / 600

2037

1/4"

- For tamper resistant torx screw
- DIN 3120



KT NO.	Size	L mm	Weight	Packaging
203708	T8H	37	14	20 / 600
203709	T9H	37	14	20 / 600
203710	T10H	37	14	20 / 600
203715	T15H	37	14	20 / 600
203720	T20H	37	15	20 / 600
203725	T25H	37	15	20 / 600
203727	T27H	37	15	20 / 600
203730	T30H	37	15	20 / 600
203740	T40H	37	16	20 / 600

HAND SOCKET & ACCESSORIES

